



Laboratory Fume Hoods & Enclosures



- *Protector® ClassMate® Laboratory Hoods*
- *Fiberglass 30 Laboratory Hoods*
- *Protector® Demonstration Hoods*

- *Basic™ Laboratory Hoods*
- *Protector® XVS™ Ventilation Stations*
- *Canopy Hoods*



Protecting your
laboratory environment

LABCONCO®



Protector® ClassMate® Laboratory Hoods

Features & Benefits

The patented* Protector ClassMate Laboratory Hoods are designed to meet the needs of instructional laboratories. Clear back and sides and taller front viewing window provide enhanced visibility for conducting chemistry demonstrations or observing

students using the hood. The clear back does not obstruct visibility when hoods are placed back-to-back in an island configuration. Protector ClassMate Hoods are offered in 4', 5' and 6' widths. Models with combination sashes are also available.

Durable and attractive frame is glacier white powder-coated steel and aluminum.

Energy-efficient, rapid-start fluorescent lighting is located behind a laminated safety glass shield and outside the hood interior for corrosion-resistance and easy replacement. Contact Labconco for ordering information on explosion-proof lighting.

Ergonomic 5° angled sash and panel allow closer, more comfortable viewing, without glare.

Clear, tempered safety glass sash, viewing panel, sides, back and baffle provide maximum visibility. All glass components except vertical-rising sashes are removable for cleaning. Laminated safety glass and solid composite sides and back are also available. Contact Labconco for ordering information.

Color-coded service fixtures for gas, air, water, vacuum and other services have remote controls for use regardless of sash position. Four service fixtures are pre-plumbed on fixtured models. Each hood is factory prepared for up to 8 service fixtures (four controlled from the front of the hood and four from the base cabinet).



By-pass airflow design ensures relatively stable face velocities.

Performance tested to ASHRAE 110.

Front panel may be easily removed for lamp replacement and access to electrical supply connections.

Streamlined corner posts provide maximum visibility and working area.

Static viewing panel above the sash frame creates a 39" viewing height, permitting the hood to be mounted in a low or high position to accommodate persons of different heights and still maintain the same visual accessibility.

Anti-racking vertical-rising sash for smooth operation may be raised from closed to 29" fully open height from the work surface for loading and cleaning. A sash stop limits the working height to 18" to help conserve energy. Exhaust volume and blower sizing are based on the 18" height. When raised, the sash does not extend above the fume hood.

Combination horizontal sliding/vertical-rising sashes are provided on some models. Two sets of integral sash stops prevent raising the vertical sash above the half-open (15") and fully-closed positions unless manually defeated by the operator.

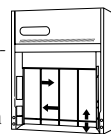

Pre-wired electrical components. Fluorescent lights and switches are factory-wired to the hood's junction boxes. Two electrical duplex receptacles are factory-wired on fixtured models.

Tissue screen located directly below the exhaust outlet prevents debris from potentially damaging the remote blower.

Large interior working depth of 26" and height of 48" provide ample space to conduct experiments.

Low profile trough below air foil contains spills. The trough is the same depth as the work surface (1.25") and requires no cabinet overhang. The air foil pivots up for cleaning.

Interior cover plates allow easy accessibility to plumbing from the front and inside of the hood.

ETL-listed. Hoods carry the ETL mark signifying that they conform to UL 61010-1 and 1805 and CAN/CSA C22.2 No. 61010-1.

Ergonomic air foil allows air to sweep the work surface for maximum containment. Clean-Sweep** airflow openings pull inflow air from under the air foil so that clean air continually flows over the air foil creating a constant barrier of protection from contaminants.



Exclusive Feature

* U.S. Design Patent No. 472,645
** U.S. Patent No. 6,461,233



Protector® ClassMate® Laboratory Hoods





4' Protector ClassMate Laboratory Hood 6970401 is shown with SpillStopper Work Surface 6986400 and Protector Acid Storage Cabinet 9901000. Blower, ductwork, work surface and base cabinet must be ordered separately.

5' Protector ClassMate Combination Sash Laboratory Hood 6971501 is shown with SpillStopper Work Surface 6986500, Protector Solvent Storage Cabinet 9902200 and Protector Acid Storage Cabinet 9901200. Blower, ductwork, work surface and base cabinets must be ordered separately.



**Requires
Ductwork and
Blower**

All models feature:

-  Patented* design.
 - Glacier white powder-coated steel and aluminum frame.
-  Ergonomic air foil with aerodynamic Clean-Sweep** airflow openings.
 - Low profile, ADA-compliant spill trough that requires no cabinet overhang.
 - Clear, 1/4" thick, tempered safety glass sides, back and removable baffle.
 - Pre-wired fluorescent lighting, light switch and blower switch for 115 volt, 60 Hz, 15 amp operation.
 - Tissue screen located directly below exhaust outlet.
 - Removable front panel and interior cover plates for access to plumbing and electrical wiring.
 - Powder-coated steel 8.6" ID exhaust connection.

Models series 69704, 69705 and 69706 also feature:

- By-pass airflow design.
- 5° angled, tempered safety glass viewing window and 3/16" thick sash with anti-racking shaft and powder-coated aluminum frames that provides 39" high visibility.

- Sash stop at 18" height from work surface (60% open). Fully open sash is 29" from work surface.

Models series 69714, 69715 and 69716 also feature:

- Combination horizontal-sliding/vertical-rising sashes that allow the operator to use the hood with sashes half open either horizontally or vertically. Sash stops at fully closed and 15" height from work surface (50% open). Sash stops at the 50% open (15") and fully-closed positions along with a sash pocket that blocks the upper by-pass and reduces amount of air exhausted.
- Highly visible yellow air foil with recessed sash track.
- 5° angled, tempered safety glass, 1/4" thick sash and stationary viewing panel** to provide viewing height of 39" for visual accessibility regardless of mounting height.
- Powder-coated steel sash pocket behind the front panel.

All models conform to the following regulations and standards:

- CFR 29, Part 1910
- SEFA 1-2010
- NFPA 45-2011
- ASHRAE 110-1995
- ANSI Z9.5-2011
- UL 61010-1
- CAN/CSA C22.2 No. 61010.1
- UL 1805
- SEFA 8-2010, Cabinet Surface Finish Tests

Models 6970401, 6970501, 6970601, 6971401, 6971501 and 6971601 feature:

- Four pre-plumbed service fixtures with forged brass valves; three with 0.25" copper tubing for use with cold water, air and vacuum, and one with 0.25" brass tubing for use with gas. **Inlet tubing is not provided.**
- Two pre-wired 115 volt, 15 amp electrical duplex receptacles.

Models 6971401, 6971501 and 6971601 also feature:

- Left-side mounted cold water rigid gooseneck faucet in place of standard service fixture.
- Pre-wired digital airflow monitor.

Required accessories not included:

- **Remote Blower.**
- **Ductwork.**
- **Work Surface.** See page 24.
- **Base Cabinet.**

Optional accessories for on-site installation include:

- **Distillation Grid Kits.**
- **Guardian Airflow Monitors.**
- **Rear Finish Panel Kits.**
- **Service Fixtures.**

Contact Labconco at **800-821-5525** or **816-333-8811** for blower sizing assistance and ordering information on accessories not included in this brochure.

*U.S. Design Patent No. 472,645

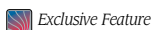

 Heights of switches, electrical receptacles and service fixtures meet requirements of ADA.



Ordering Information & Dimensional Data

Protector® ClassMate® Laboratory Hoods

Catalog Number	Total Exhaust CFM and Static Pressure at 18" sash opening height (60% open)*					
	100 fpm	S.P.	80 fpm	S.P.	60 fpm	S.P.
6970400, 6970401	570	0.24"	460	0.16"	340	0.09"
6970500, 6970501	730	0.39"	590	0.26"	440	0.14"
6970600, 6970601	890	0.51"	710	0.33"	540	0.19"

*Contact Labconco for other sash opening height data.

Catalog Number	Total Exhaust CFM and Static Pressure at 50% sash opening height horizontally or vertically					
	100 fpm	S.P.	80 fpm	S.P.	60 fpm	S.P.
6971400, 6971401	470	0.16"	380	0.11"	280	0.06"
6971500, 6971501	550	0.22"	440	0.14"	330	0.08"
6971600, 6971601	680	0.30"	550	0.20"	410	0.11"

Nominal Width	Catalog Number	Fluorescent Lamps	Service Fixtures	Electrical Duplexes	Digital Monitor	Shipping Weight lbs./kg
4 Feet	6970400	2 ea. 30 watt	None	None	No	400/181
4 Feet	6970401	2 ea. 30 watt	4	2	No	400/181
4 Feet	6971400	2 ea. 30 watt	None	None	No	485/220
4 Feet	6971401	2 ea. 30 watt	4*	2	Yes	485/220
5 Feet	6970500	2 ea. 40 watt	None	None	No	460/209
5 Feet	6970501	2 ea. 40 watt	4	2	No	460/209
5 Feet	6971500	2 ea. 40 watt	None	None	No	570/259
5 Feet	6971501	2 ea. 40 watt	4*	2	Yes	570/259
6 Feet	6970600	2 ea. 40 watt	None	None	No	550/249
6 Feet	6970601	2 ea. 40 watt	4	2	No	550/249
6 Feet	6971600	2 ea. 40 watt	None	None	No	680/308
6 Feet	6971601	2 ea. 40 watt	4*	2	Yes	680/308

*Includes one rigid gooseneck faucet for cold water.

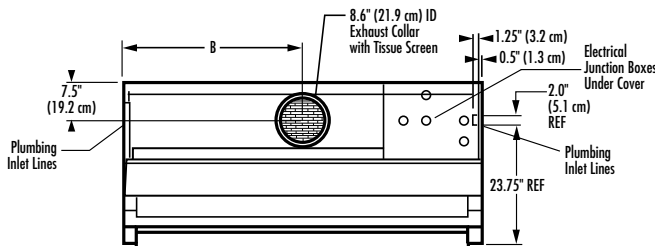

TOP (All Models)

	A*	B*	C*	D*	E*
6970400, 6970401	48.0 (121.9)	24.0 (61.0)	45.0 (114.3)	N/A	25.75 (65.4)
6971400, 6971401	48.0 (121.9)	24.0 (61.0)	45.0 (114.3)	N/A	26.25 (66.7)
6970500, 6970501	60.0 (152.4)	30.0 (76.2)	57.0 (144.8)	N/A	25.75 (65.4)
6971500, 6971501	60.0 (152.4)	30.0 (76.2)	57.0 (144.8)	26.0 (66.0)	26.25 (66.7)
6970600, 6970601	72.0 (182.9)	36.0 (91.4)	69.0 (175.3)	N/A	25.75 (65.4)
6971600, 6971601	72.0 (182.9)	36.0 (91.4)	69.0 (175.3)	32.0 (81.3)	26.25 (66.7)

*Inches (centimeters)

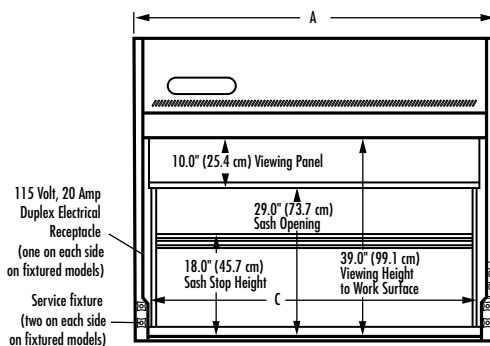

FRONT
(Model series 69704,
69705 and 69706)

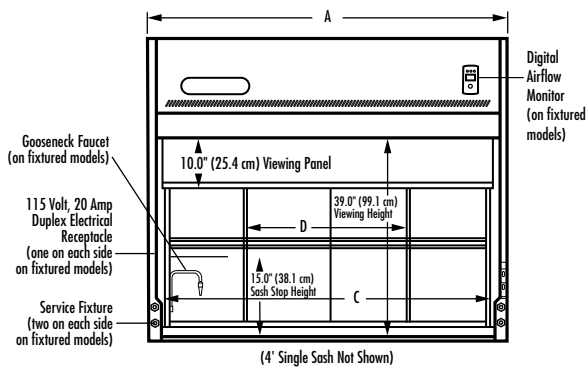

FRONT
(Model series 69714,
69715 and 69716)

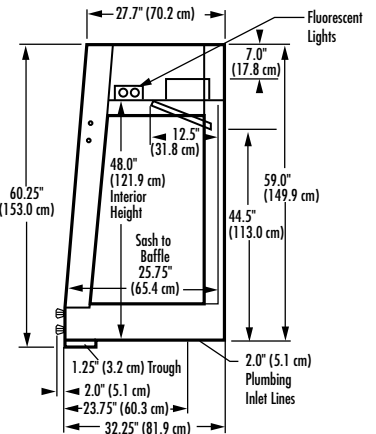

SIDE
(All Models)

Contact Labconco at 800-821-5525 or 816-333-8811 for detailed AutoCAD drawings.



Accessories

Protector® ClassMate® Laboratory Hoods



SpillStopper™ Work Surfaces

Molded from a special formulation of corrosion-resistant epoxy resins. Dished and contoured to conform to the interior liner of Protector ClassMate Laboratory Hoods. May be ordered with an oval cupsink cutout in the right or left rear. Cupsink is sold separately. See below. See page 24 for deck-mounted accessories, which require custom cutouts.

Catalog #	Description	Shipping Wt. lbs./kg
6986400	4' w x 25.9" d, no cutouts	110/50
6986401	4' w x 25.9" d, cupsink cutout, left rear	110/50
6986402	4' w x 25.9" d, cupsink cutout, right rear	110/50
6986403	4' w x 25.9" d, cupsink cutouts, left and right rear	110/50
6986500	5' w x 25.9" d, no cutouts	150/68
6986501	5' w x 25.9" d, cupsink cutout, left rear	150/68
6986502	5' w x 25.9" d, cupsink cutout, right rear	150/68
6986503	5' w x 25.9" d, cupsink cutouts, left and right rear	150/68
6986600	6' w x 25.9" d, no cutouts	205/93
6986601	6' w x 25.9" d, cupsink cutout, left rear	205/93
6986602	6' w x 25.9" d, cupsink cutout, right rear	205/93
6986603	6' w x 25.9" d, cupsink cutouts, left and right rear	205/93

Dimensional Data

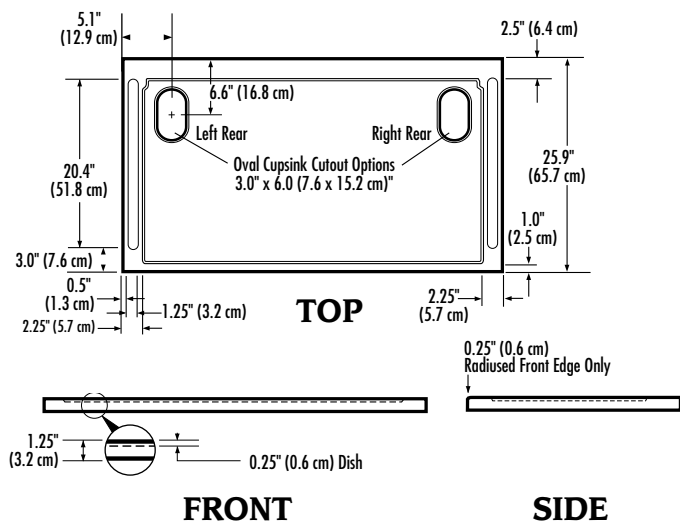

4005200 Oval Polypropylene Cupsink

Mounts in work surface with cupsink cutout. 3" x 6". 1.5" National Pipe Straight Mechanical thread. Shipping weight 4 lbs. (1.8 kg)

Rear Finish Panel Kits

The panel hides the hood's interior components. Recommended when hood is mounted on a casework island (and exposed on the back), each kit includes a glacier white powder-coated steel panel to provide a finished appearance for the rear of the hood.

Catalog #	Nominal Width	Dimensions (w x h)	Shipping Wt. lbs./kg
6987300	4 Feet	43" x 9.5"	20/9
6987301	5 Feet	55" x 9.5"	25/12
6987302	6 Feet	67" x 9.5"	30/14

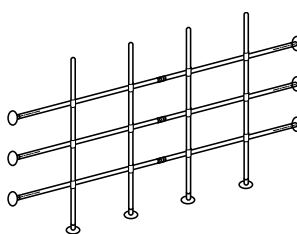

Distillation Grid Kits

Kits include stainless steel rods, connectors, instruction sheet and drill template.

Catalog #	Nominal Width	Shipping Wt. lbs./kg
6973300	4 Feet	15/7
6973301	5 Feet	20/9
6973302	6 Feet	25/11



9743203 Guardian™ 335 Digital Airflow Monitor Kit

For use on Protector ClassMate Laboratory Hoods only. Monitors and alerts the operator to low airflow conditions. Includes face plate with circuit board, electrical power pack, vinyl tubing, side wall flow tube adapter and wiring instructions. From the monitor's face plate, the user can easily select and calibrate a setpoint between 50 and 250 fpm using a velocity meter. An LCD displays actual face velocity. If the hood's face velocity falls below the programmable setpoint, an audible alarm sounds and the LOW indicator glows red. The TEST RESET switch, when pressed, mutes the audible alarm. The EMERG. PURGE switch, when configured and pressed, can be used to activate a relay to open a hood damper (not included). **Requires cutout in upper right portion of front panel.**



9743204 Guardian™ Jr. Airflow Monitor Kit

For use on Protector ClassMate Laboratory Hoods only. Monitors and alerts the operator to low airflow conditions. Includes face plate with circuit board, electrical power pack, vinyl tubing and airflow tube adapter. From the monitor's face plate, the user can easily select and calibrate a setpoint between 30 and 250 fpm using a velocity meter and a screwdriver. If the hood's face velocity falls below the setpoint for more than 6 seconds, an audible alarm sounds and the ALERT indicator glows red. The TEST RESET switch, when pressed, mutes the alarm. **Requires cutout in upper right portion of front panel.** Shipping weight 6 lbs. (2.7 kg)



Basic 47 Laboratory Hood with built-in blower 2247300 is shown with Flat Solid Epoxy Work Surface 4882803 and Protector Acid Storage Cabinet 9901000.

Inset: Basic 70 Laboratory Hood 2246400 is shown with Flat Solid Epoxy Work Surface 4882804 and two Protector Standard Storage Cabinets 9900100.





Basic™ Laboratory Hoods

Features & Benefits

Basic 47 and 70 Laboratory Hoods are designed for modular laboratories, classrooms and light duty applications where safe ventilation is required.

Constructed of powder-coated steel, Basic Hoods are economical and have a smaller overall height and depth than traditional hoods so they fit in areas with low ceilings or narrow aisles. Choose from 4' and 6' widths.

Front panel may be removed for access to blower and electrical connections.



Versatile blower mounts on top of the hood liner or in a remote location. Hoods are also available without blower.

CE mark*. Contact Labconco for specific 230 volt, 50 Hz models that conform to CE (European Community) requirements for electrical safety and electromagnetic compatibility.

Two-piece baffle is adjustable.

Durable and attractive exterior is glacier white powder-coated steel.

Vapor-proof incandescent lighting illuminates the interior. Explosion-proof models include an explosion-proof incandescent light fixture (bulb not included).

Top of the hood liner is factory-prepared to accommodate two customer-supplied apparatus rods.

Vertical-rising tempered safety glass sash protects the operator while providing excellent visibility.

ETL-listed. Hoods carry the ETL mark signifying that they are certified to UL 61010-1 and CAN/CSA C22.2 No. 61010.1.

The curved air foil directs airflow into the hood to minimize turbulence and ensure fume containment. The foil lifts off for cleaning.

Unassembled models available. Components fit into a carton less than one half its assembled size. The compact container is more economical to ship and store than assembled hood cartons and transports readily to remote locations. Assembly is simple and fast. **Unassembled models are not pre-wired.**

Performance tested to ASHRAE 110.

The right interior wall is factory-prepared to accommodate an accessory cupsink and turret (sold separately).

Compact dimensions accommodate tight installations. The 48" height, 53" with built-in blower, makes it ideal for laboratories with lower ceiling heights. Overall depth of 25" makes it adaptable to shallow cabinetry.

Durable powder-coated 16 gauge steel liner resists chemical degradation.

Pre-wired electrical components. Incandescent lighting and switches are factory-wired to the hood's junction box. **Explosion-proof models are furnished without switches and wiring as these must conform to varying local codes.**

* Contact Labconco for specific models.

Exclusive Feature





Basic™ Laboratory Hoods



Basic 47 Laboratory Hood 2247300 is shown with Flat Solid Epoxy Work Surface 4882803 and Protector Acid Storage Cabinet 9901000. Blower module is included. Ductwork, work surface and base cabinet must be ordered separately.

All models feature:

- By-pass airflow design.
- Curved air foil that lifts off for cleaning.
- Glacier white powder-coated, 16 gauge steel exterior and interior.
- Two-piece adjustable baffle.
- 3/16" thick tempered safety glass, vertical-rising sash with epoxy-coated aluminum sash handle.
- Removable front panel for access to electrical wiring.
- Factory-prepared right side fixture panel for up to three service fixtures, one duplex electrical receptacle and one airflow monitor (fixtures, receptacle and monitor not included).
- Factory-prepared right interior wall for one cupsink and turret (cupsink and turret not included).
- Powder-coated steel 10.3" OD exhaust connection.

All models conform to the following regulations and standards:

- CFR 29, Part 1910
- SEFA 1-2010
- NFPA 45-2011
- ASHRAE 110-1995
- ANSI Z9.5-2011
- UL 61010-1
- CAN/CSA C22.2 No. 61010.1
- UL 1805
- SEFA 8-2010, Cabinet Surface Finish Tests
- CE Conformity Marking (220 volt models)*

Vapor-proof models feature:

- Pre-wired 100-watt vapor-proof incandescent light, light and blower switches.

Explosion-proof models feature:

- Explosion-proof incandescent light fixture. (Requires installation. Bulb not included.)
- **Furnished without switches and wiring as these must conform to varying local codes.**

Models with blower module feature:

- Belt-driven blower with adjustable sheave.
- Powder-coated steel base and housing.
- Corrosion-resistant coated aluminum impeller.

Unassembled models feature:

- Basic 47 Hood carton dimensions: 51" w x 39" d x 14.5" h.
- Basic 70 Hood carton dimensions: 74" w x 39" d x 14.5" h.
- Blower carton dimensions (if applicable): 20" w x 28" d x 16" h.

Required accessories not included:

- **Blower.****
- **Ductwork.**
- **Work Surface.** See page 24.
- **Base Cabinet or Stand.**

Optional accessories for on-site installation include (see page 11):

- **Service Fixture Kits.**
- **Electrical Duplex Kits.**
- **Guardian Airflow Monitor Kits.**
- **Cupsink and Turret Kit.**
- **Sash Stop Kit.**
- **Right Side Finish Panel Kit.**

Contact Labconco at **800-821-5525** or **816-333-8811** for blower sizing assistance and ordering information on accessories not included in this brochure.

*Contact Labconco for specific models.

**Many models include a blower module.

Heights of switches, electrical receptacles and service fixtures meet requirements of ADA.



Ordering Information & Dimensional Data

Basic™ 47 Laboratory Hoods

Basic 47 Hoods with Blower Module

Capable of overcoming a maximum external static pressure of .25" H₂O at 720 CFM (100 fpm).

Overall dimensions: 47.0" wide x 25.0" deep x 53.0" high (with blower module mounted on top of hood).

Nominal Width	Catalog Number	Electrical Requirements	Incandescent Lamp	Blower Motor	Equivalent Resistance* 10" dia. 12" dia.		Assembly Configuration	Shipping Weight lbs./kg
4 Feet	2247300	115 volts, 60 Hz	Vapor-Proof	1/3 hp	100'	250'	Fully Assembled	370/168
4 Feet	2247301**	220 volts, 50 Hz	Vapor-Proof	1/2 hp	100'	250'	Fully Assembled	370/168
4 Feet	2247500	115/230 volts, 60 Hz	EP†	1/3 hp, EP	100'	250'	Fully Assembled	375/170
4 Feet	2247501**	220 volts, 50 Hz	EP†	1/3 hp, EP	100'	250'	Fully Assembled	375/170
4 Feet	2246603	115 volts, 60 Hz	Vapor-Proof	1/3 hp	100'	250'	Unassembled	272/123 29/13††
4 Feet	2246604**	220 volts, 50 Hz	Vapor-Proof	1/2 hp	100'	250'	Unassembled	272/123 29/13††
4 Feet	2246605	115/230 volts, 60 Hz	EP†	1/3 hp, EP	100'	250'	Unassembled	272/123 41/19††
4 Feet	2246606**	220 volts, 50 Hz	EP†	1/3 hp, EP	100'	250'	Unassembled	272/123 41/19††

Basic 47 Hoods for use with remote blower

Static pressure loss does not exceed .35" H₂O at 100 fpm (720 CFM). Overall dimensions: 47.0" wide x 25.0" deep x 48.0" high.

Nominal Width	Catalog Number	Electrical Requirements	Incandescent Lamp	Assembly Configuration	Shipping Weight lbs./kg
4 Feet	2247400	115 volts, 60 Hz	Vapor-Proof	Fully Assembled	275/125
4 Feet	2247401**	220 volts, 50 Hz	Vapor-Proof	Fully Assembled	275/125
4 Feet	2246600	115 volts, 60 Hz	Vapor-Proof	Unassembled	272/123
4 Feet	2246601**	110/220 volts, 50 Hz	Vapor-Proof	Unassembled	272/123
4 Feet	2246602	115/230 volts, 50/60 Hz	EP†	Unassembled	272/123

EP = explosion-proof

*Maximum length of straight duct to achieve 100 fpm face velocity

** International electrical configuration

†Bulb not included

††Shipping weight of separate blower carton

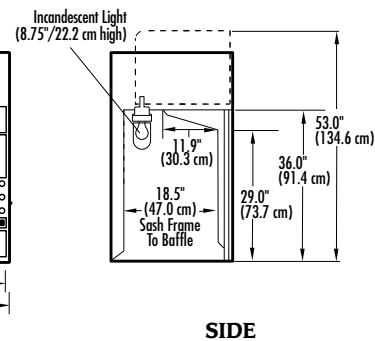
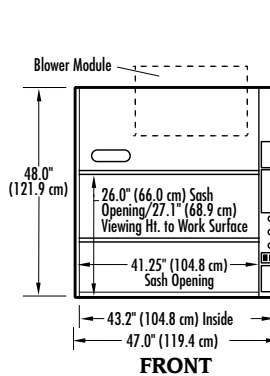
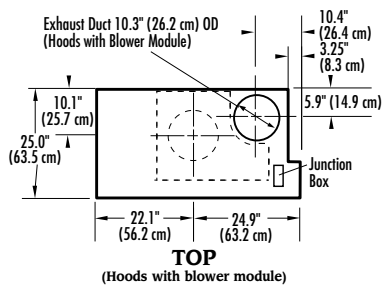
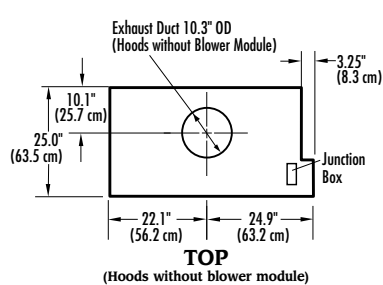

See page 11 for blower module detail.



Ordering Information & Dimensional Data

Basic™ 70 Laboratory Hoods

Basic 70 Hoods with Blower Module

Capable of overcoming a maximum external static pressure of .23" H₂O at 1120 CFM (100 fpm).

Overall dimensions: 70.0" wide x 25.0" deep x 53.0" high (with blower module mounted on top of hood).

Nominal Width	Catalog Number	Electrical Requirements	Incandescent Lamp	Blower Motor	Equivalent Resistance* 10" dia. 12" dia.		Assembly Configuration	Shipping Weight lbs./kg
6 Feet	2246300	115 volts, 60 Hz	Vapor-Proof	3/4 hp	45'	100'	Fully Assembled	450/204
6 Feet	2246301**	220 volts, 50 Hz	Vapor-Proof	3/4 hp	45'	100'	Fully Assembled	450/204
6 Feet	2246500	115/230 volts, 60 Hz	EP [†]	3/4 hp, EP	45'	100'	Fully Assembled	455/206
6 Feet	2246501**	220 volts, 50 Hz	EP [†]	3/4 hp, EP	45'	100'	Fully Assembled	455/206
6 Feet	2246703	115 volts, 60 Hz	Vapor-Proof	3/4 hp	45'	100'	Unassembled	426/193 29/13 ^{††}
6 Feet	2246704**	220 volts, 50 Hz	Vapor-Proof	3/4 hp	45'	100'	Unassembled	426/193 41/19 ^{††}
6 Feet	2246705	115/230 volts, 60 Hz	EP [†]	3/4 hp, EP	45'	100'	Unassembled	426/193 41/19 ^{††}
6 Feet	2246706**	220 volts, 50 Hz	EP [†]	3/4 hp, EP	45'	100'	Unassembled	426/193 41/19 ^{††}

Basic 70 Hoods for use with remote blower

Static pressure loss does not exceed .57" H₂O at 100 fpm (1120 CFM). Overall dimensions: 70.0" wide x 25.0" deep x 48.0" high.

Nominal Width	Catalog Number	Electrical Requirements	Incandescent Lamp	Assembly Configuration	Shipping Weight lbs./kg
6 Feet	2246400	115 volts, 60 Hz	Vapor-Proof	Fully Assembled	430/195
6 Feet	2246401**	220 volts, 50 Hz	Vapor-Proof	Fully Assembled	430/195
6 Feet	2246700	115 volts, 60 Hz	Vapor-Proof	Unassembled	426/193
6 Feet	2246701**	110/220 volts, 50 Hz	Vapor-Proof	Unassembled	426/193
6 Feet	2246702	115/230 volts, 50/60 Hz	EP [†]	Unassembled	426/193

EP = explosion-proof

*Maximum length of straight duct to achieve 100 fpm face velocity

** International electrical configuration

[†]Bulb not included

^{††}Shipping weight of separate blower carton

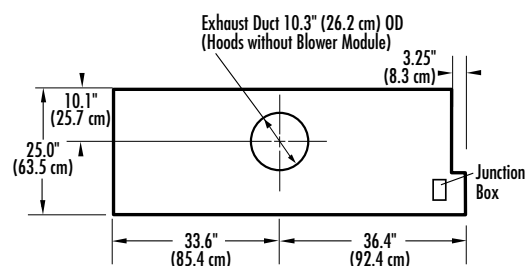

TOP
(Hoods without blower module)

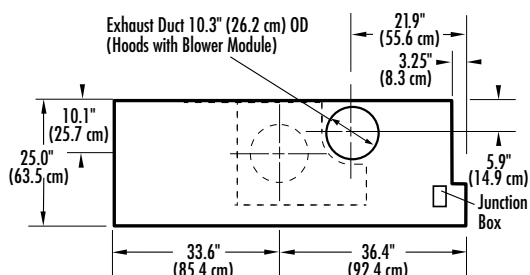

TOP
(Hoods with blower module)

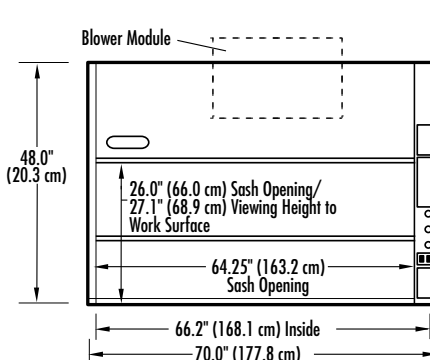

FRONT

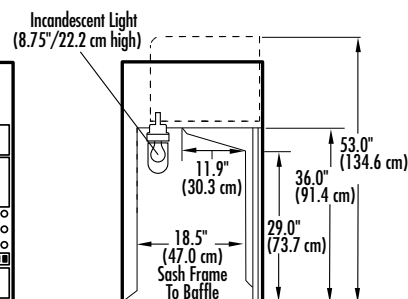

SIDE

See page 11 for blower module detail.



Accessories

Basic™ Laboratory Hoods



Guardian™ Jr. Airflow Monitor Kits

Audible/visual alarm alerts user to low face velocity. For installation in a factory-prepared cutout on upper portion of right side fixture panel. Shipping weight 6 lbs. (3 kg)

Catalog # Description

9743208	Guardian Jr. Airflow Monitor for 115 volt, 60 Hz operation
9743210**	Guardian Jr. Airflow Monitor for 230 volt, 50 Hz operation

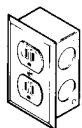

Duplex Electrical Receptacle Kits

Each kit includes duplex electrical receptacle, junction box and receptacle cover plate. For mounting on the lower right side fixture panel. **Electrical wiring is not included.**

Catalog #	Kit	Shipping Wt.
4844400	115 volts, 20 amps AC	4 lbs. (2 kg)
4844401	115 volts, 20 amps AC, GFCI	4 lbs. (2 kg)

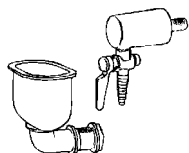

4852500 Cupsink and Turret Kit

Polypropylene cupsink, 3" x 6", and chrome turret mount on right side wall. **Plumbing pipe is not included.** Shipping weight 0.5 lb. (0.2 kg)

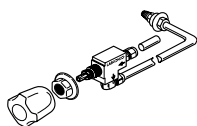

Standard Service Fixture Kits

Each kit includes one remotely-controlled service fixture with 0.25" diameter valve and tubing, color-coded fixture knob and color-coded hose connector. For mounting on the right side fixture panel. Shipping weight 4 lbs. (2 kg.)

Catalog #	Kit	Tubing	Valve	Knob/ Connector Color	Maximum Flow Rate	Maximum Working Pressure*
2832600	Cold Water (CW)	Copper	Brass	Green	3.5 GPM (13.2 LPM)	40 psi
2832601	Hot Water (HW)	Copper	Brass	Red	3.5 GPM (13.2 LPM)	40 psi
2832602	Deionized/ Distilled Water (DI)	Stainless Steel	Nickel-Plated/ Stainless Steel	White	3.5 GPM (13.2 LPM)	40 psi
2832603	Vacuum (VAC)	Copper	Brass	Yellow	8.6 CFM	14.7 psi
2832604	Air (AIR)	Copper	Brass	Orange	23.7 CFM	40 psi
2832605	Gas (GAS)	Brass	Brass	Blue	29.0 CFM (441 BTU/sec)	40 psi
2832606	Nitrogen (NIT)	Copper	Brass	Brown	24.1 CFM	40 psi
2832607	Argon (ARG)	Copper	Brass	Gray	20.2 CFM	40 psi
2832608	Steam (STM)	Copper	Brass	Black	0.5 LBM/min	40 psi

GPM = gallons per minute LPM = liters per minute CFM = cubic feet per minute BTU/sec = British thermal unit per second LBM/min = pounds mass per minute
* Maximum allowable pressure is 200 psi with a working pressure of 40 psi. ** International electrical configuration



Guardian™ Digital Airflow Monitor Kits

An LCD displays average face velocity. Audible/visual alarm alerts user to low or high face velocity. For installation in a factory-prepared cutout on upper portion of right side fixture panel. Shipping weight 6 lbs. (3 kg)

Catalog # Description

9743207	Guardian Digital Airflow Monitor for 115 volt, 60 Hz operation
9743209**	Guardian Digital Airflow Monitor for 230 volt, 50 Hz operation

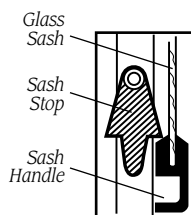

4965901 Sash Stop Kit

The Sash Stop restricts how far the sash may be opened. This small plastic device may be easily installed on the left side of Basic Hoods to restrict sash opening height. Shipping weight 0.5 lb. (0.2 kg)

4878600 Right Side Finish Panel Kit

Recommended. Includes a glacier white powder-coated steel panel to provide a finished appearance to the right side of the hood. The panel hides the exposed plumbing when service fixtures are installed. Not for use with 4852500 Cupsink and Turret. Shipping weight 20 lbs. (9 kg)

Blower Module Detail

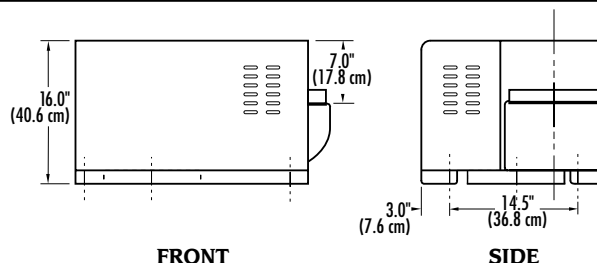
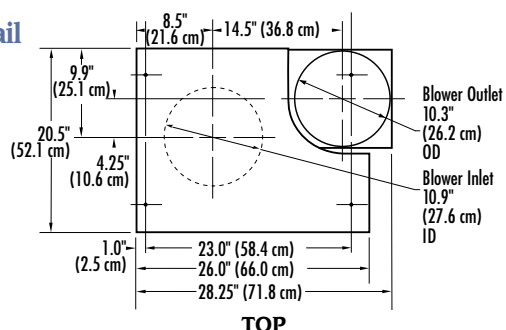



Fiberglass 30 Laboratory Hoods



Requires
Ductwork and
Blower



Fiberglass 30 Laboratory Hood 3030002 is shown with Flat Solid Epoxy Work Surface 4882806 and Protector Standard Storage Cabinet 9900200. Remote blower, ductwork, work surface and base cabinet must be ordered separately.

Compact Fiberglass 30 Laboratory Hoods are designed for research, educational and clinical applications requiring small working space and efficient fume removal. Like the Protector Premier line, these hoods feature a corrosion-resistant, one-piece molded fiberglass liner.

All models feature:

- By-pass airflow design.
- Durable glacier white powder-coated steel exterior.
- One-piece molded fiberglass interior and pre-set baffle with flame spread index less than 25 per ASTM E-84.
- 3/16" thick tempered safety glass vertical-rising sash with powder-coated aluminum handle.
- Pivoting air foil.
- Right side fixture panel factory-prepared to accept up to three service fixtures, one electrical duplex and one airflow monitor (kits are sold separately).
- 6.7" ID fiberglass exhaust connection.

All models conform to the following regulations and standards:

- CFR 29, Part 1910
- SEFA 1-2010
- NFPA 45-2011
- ASHRAE 110-1995
- ANSI Z9.5-2011
- UL 61010-1
- CAN/CSA C22.2 No. 61010.1
- UL 1805
- SEFA 8-2010, Cabinet Surface Finish Tests
- CE Conformity Marking (230 volt models)*

Models 3030000 and 3030001 feature:

- Built-in corrosion-resistant, direct drive exhaust blower capable of overcoming a maximum external static pressure of 0.12" H₂O at 310 CFM (100 fpm).
- Pre-wired 100 watt, vapor-proof incandescent lighting, light and blower switches.

Models 3030002 and 3030003:

- Designed for use with remote blower (not included).
- Static pressure loss does not exceed 0.14" H₂O at 100 fpm (310 CFM).
- Pre-wired 100 watt, vapor-proof incandescent lamp, light and blower switches.

Models 3030004 and 3030005 feature:

- Built-in corrosion-resistant, explosion-proof, direct drive exhaust blower capable of overcoming a maximum external static pressure of 0.12" H₂O at 310 CFM (100 fpm).
- **Furnished without light, switches or wiring. Wiring must conform to local codes.** (Explosion-proof Light Fixture Kit is available. See page 13.)

Required accessories not included:

- **Ductwork.**
- **Work Surface.** See page 24.
- **Base Cabinet or Stand.**

Optional accessories for on-site installation include (see page 13):

- **Service Fixture Kits.**
- **Electrical Duplex Kits.**
- **Guardian Airflow Monitor Kits.**
- **Explosion-Proof Light Fixture Kit.**

Contact Labconco at **800-821-5525** or **816-333-8811** for blower sizing assistance and ordering information on accessories not included in this brochure.

*Contact Labconco for specific models.

Ordering Information

Catalog Number	Built-in Blower	Equivalent Resistance**		Electrical Requirements	Vapor-Proof Lamp	Dimensions (w x d x h)	Shipping Weight lbs./kg
		6" dia.	8" dia.				
3030000	1/10 HP, Std.	20'	80'	115 volts, 60 Hz	100 watt	30.0" x 30.2" x 48.0"	230/104
3030001[†]	1/3 HP, Std.	20'	80'	230 volts, 50 Hz	100 watt	30.0" x 30.2" x 52.0"	230/104
3030002	None	—	—	115 volts, 60 Hz	100 watt	30.0" x 30.2" x 48.0"	210/95
3030003[†]	None	—	—	230 volts, 50 Hz	100 watt	30.0" x 30.2" x 48.0"	210/95
3030004	1/4 HP, EP	20'	80'	115 volts, 60 Hz	None	30.0" x 30.2" x 54.0"	240/109
3030005[†]	1/3 HP, EP	20'	80'	230 volts, 50 Hz	None	30.0" x 30.2" x 54.0"	240/109

EP = Explosion-proof

**Maximum length of straight duct to achieve 100 fpm face velocity

[†]International electrical configuration



Accessories & Dimensional Data

Fiberglass 30 Laboratory Hoods

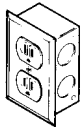

Duplex Electrical Receptacle Kits

Each kit includes duplex electrical receptacle, wiring, junction box and receptacle cover plate. For mounting on the lower right side fixture panel.

Catalog #	Kit	Shipping Wt.
2834800	115 volts, 20 amps AC	4 lbs. (2 kg)
2834801	115 volts, 20 amps AC, GFCI	4 lbs. (2 kg)

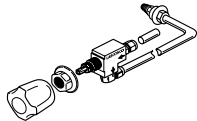

Standard Service Fixture Kits

Each kit includes one remotely-controlled service fixture with 0.25" diameter valve and tubing, color-coded fixture knob and color-coded hose connector. For mounting on the right side fixture panel. Shipping weight 4 lbs. (2 kg.)

Catalog #	Kit	Tubing	Valve	Knob/Connector Color
2832600	Cold Water (CW)	Copper	Brass	Green
2832601	Hot Water (HW)	Copper	Brass	Red
2832602	Deionized/ Distilled Water (DI)	Stainless Steel	Nickel-Plated/ Stainless Steel	White
2832603	Vacuum (VAC)	Copper	Brass	Yellow
2832604	Air (AIR)	Copper	Brass	Orange
2832605	Gas (GAS)	Brass	Brass	Blue
2832606	Nitrogen (NIT)	Copper	Brass	Brown
2832607	Argon (ARG)	Copper	Brass	Gray
2832608	Steam (STM)	Copper	Brass	Black



Guardian™ Digital Airflow Monitor Kits

An LCD displays average face velocity. Audible/visual alarm alerts user to low or high face velocity. For installation in a factory-prepared cutout on upper portion of right side fixture panel. Shipping weight 6 lbs. (3 kg)

Catalog #	Description
9743201	Guardian Digital Airflow Monitor for 115 volt, 60 Hz operation
9743205*	Guardian Digital Airflow Monitor for 230 volt, 50 Hz operation



Guardian™ 500 Airflow Monitor Field Installation Kits

Audible/visual alarm alerts user to low face velocity. For installation in a factory-prepared cutout on upper portion of right side fixture panel. Shipping weight 6 lbs. (3 kg)

Catalog #	Description
9743213	Guardian 500 Airflow Monitor for 115 volt, 60 Hz operation
9743214*	Guardian 500 Airflow Monitor for 230 volt, 50/60 Hz operation

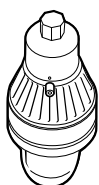

4892900 Explosion-Proof Light Fixture Kit

For mounting on Fiberglass 30 Hood 30300004 or 30300005. Includes explosion-proof incandescent light fixture, mounting hardware and instructions. 13" h x 7" diameter. 150 Watt maximum. Suitable for Class I, Group C & D and Class II, Group E & G room classifications per National Fire Protection Association (NFPA) 70. **Bulb and electrical wiring are not included.** Shipping weight 11 lbs. (5 kg)

* International electrical configuration

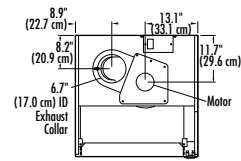

3030000
(with Built-in Blower)

TOP

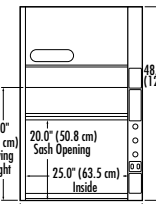

FRONT

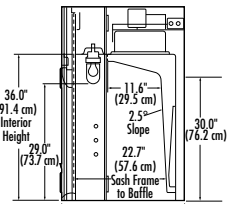

SIDE

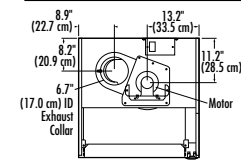

3030001
(with Built-in Blower)

TOP

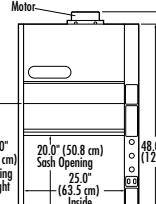

FRONT

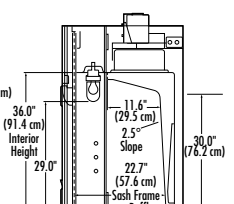

SIDE

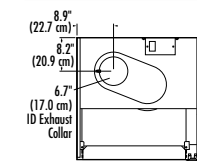

3030002 and 3030003
(for use with Remote Blower)

TOP

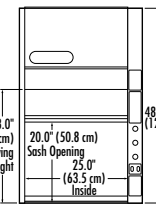

FRONT

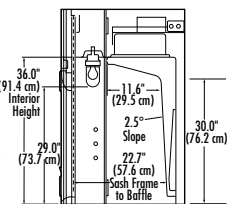

SIDE

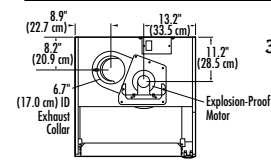

3030004 and 3030005
(with Built-in
Explosion-Proof Blower)

TOP

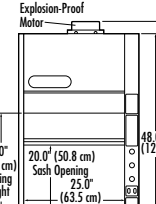

FRONT

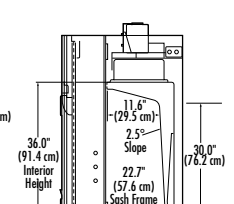

SIDE



3' Protector XVS Ventilation Station 4863010 is shown with FilterMate Portable Exhauster 3970001, Solid Epoxy Dished Work Surface 3908401 and Telescoping Base Stand with Casters 3746711.

Inset: 3' Protector XVS Ventilation Station 4863030 is shown with Solid Epoxy Dished Work Surface 3908401 and Telescoping Base Stand 3746701.



Requires
Ductwork and
Blower



Protector[®] XVS[™] Ventilation Stations

Features & Benefits

Protector XVS Ventilation Stations provide an economical alternative to traditional fume hoods. With their low profile and clear sides, top and sash, Protector XVS Ventilation Stations are well suited for classroom and educational laboratory environments where supervision or demonstrations are required. They may also be used as weighing stations, light duty fume hoods, solvent cleaning work bays, and veterinary pathology and cytology enclosures. With smaller working heights and available in widths from 2', XVS Stations exhaust less tempered room air and conserve more energy

than traditional hoods. They have no switches, wiring or service fixtures that add incremental costs.

Protector XVS Stations may be connected to a remote blower and exhausted to the outside. Alternatively, they may be connected to the FilterMate Portable Exhauster(s), which uses a carbon filter(s), a HEPA filter(s) or HEPA/carbon filter combination to remove fumes and vapors and/or hazardous particulates from the exhaust air without ducting.

Tempered safety glass front sash, sides and top offer excellent visibility, ambient light and protection. Glass provides better fire, scratch and chemical resistance than acrylic and dissipates static charge.

Sturdy glacier white and gray powder-coated aluminum frame and steel rear plenum and baffle dissipate static charge and provide durability and better chemical resistance compared to acrylic models. No plastic-to-plastic bonding is used.

Upper dilution air supply introduces room air at the top of the sash to dilute contaminants in the upper chamber and bathes the back of the sash with clean air.

Patented* rear baffle with zones of perforations promotes horizontal laminar airflow to maximize containment. The baffle pivots down and is easily removable for cleaning.

Ergonomic angled sash allows a closer view, reduces glare and provides a more comfortable operating position than vertical sashes.

Patented* upper containment sash foil bleeds air into the enclosure to direct concentrations of contaminants away from the operator's breathing zone.

Deep interior easily accommodates a variety of apparatus including large balances. Models are available with a 23.4" interior depth. Some 5', 6' and 8' models have 30.0" interior depths.

8", 10" or 12" high sash opening limits exhaust demand, conserves costly tempered room air and requires a smaller remote blower than most fume hoods.

Flexible exhaust options. Rectangular exhaust openings on the top and bottom allow the Protector XVS Ventilation Station to be connected to ductwork for exhausting to the outside or to FilterMate[™] Portable Exhauster(s) for filtered removal of fumes, particulates or powders. Using the bottom exhaust opening keeps ductwork hidden, maximizing room visibility.

Two utility ports allow passage of tubing, electrical cords and interface cables from inside to back exterior for connection to services.

Modified ASHRAE 110-1995 conformity independently verified by ECT, Inc.

Particulate containment independently verified by SafeBridge Consultants, Inc.**

Side-entry air foils allow air to sweep across the interior glass surfaces to enhance containment.

Patented* Clean-Sweep[™] air foil allows air to sweep the work surface for maximum containment. Airflow openings pull inflow air from under the air foil so that clean air continually flows through the air foil creating a constant barrier of protection from contaminants.

Low profile design requires less space than most ventilated enclosures.



Left-side mounted waste chute, standard on some 5', 6' and 8' models, isolates contaminated waste in a sealable bag.

Exclusive Feature

* U.S. Patent No. 6,461,233

**Contact Labconco for more information.



Protector® XVS™ Ventilation Stations



At far left: 8' Protector XVS Ventilation Station 4868060 is shown with Solid Epoxy Dished Work Surface 3908411 and Protector Standard Storage Cabinets 9904300 and 9904000. Blower, ductwork, work surface and supporting base must be ordered separately. At left: 2' Protector XVS Ventilation Station 4862030 is shown with Solid Epoxy Dished Work Surface 3908400 and Telescoping Base Stand 3747000. Blower, ductwork, work surface and supporting base must be ordered separately.



Requires
Ductwork and
Blower

All models feature:

- By-pass airflow design.
- Deep interior of 23.4" or 30.0" depending on the model.
- Clean-Sweep* air foil.
- Upper dilution air supply.
- Upper containment sash foil.
- Zone-perforated, pivoting rear baffle.*
 - Side-entry air foils.
- Glacier white and gray powder-coated aluminum frame and steel rear plenum and baffle. No plastic-to-plastic bonding is used.
- Clear 3/16" thick top and sides and 1/4" thick sash.
- Ergonomic 20° angled and hinged, pivoting sash with wiping seal. Sashes on 5', 6' and 8' models incorporate an external gas-assist lift.
- Models with 8.0" sash opening height have 16.5" locking height and 19.0" maximum loading height. Models with 10.0" or 12.0" sash opening height have 25.75" locking height and 28.25" maximum loading height.
- Two utility ports with iris openings and plastic plugs.
- 2" x 10" rectangular exhaust openings at the top and bottom. 5', 6' and 8' models include three openings on the top and bottom. Cover(s) provided for unused openings.
- Particulate containment independently verified by SafeBridge Consultants, Inc.††
- Modified ASHRAE 110-1995 conformity as low as 50 fpm independently verified by ECT, Inc.††

All models conform to the following regulations and standards:

- SEFA 1-2010
- Modified ASHRAE 110-1995
- ANSI Z9.5-2011
- SEFA 8-2010, Cabinet Surface Finish Tests

5', 6' and 8' models with 35.5" exterior depth include:

- Left-side mounted waste chute. Bags not included. Minimum bag size required: 10" x 16".

Required accessories not included:

- **Remote blower or FilterMate Portable Exhauster(s).** See pages 20-22 and 27.
- **Work surface.** See page 25.

Supporting base.

- **Ductwork.** See pages 26-27 and back cover.

Optional accessories (see pages 26-27 and back cover:

- **Guardian Airflow Monitors.** See back cover.
- **Fluorescent Task Lights.**
- **Utility Shelves, Bottle Holder and Tissue Holder.**
- **Exhaust Transition Adapters.**
- **Waste Chute Stopper.**
- **Waste Chute Bags.** Contact your laboratory supply dealer.

Contact Labconco at **800-821-5525** or **816-333-8811** for blower sizing assistance and ordering information on accessories not included in this brochure.

Nominal Width	Height	Sash Opening Ht.	Total Exhaust CFM and Static Pressure (w.g.)					
			100 fpm	S.P.	80 fpm	S.P.	60 fpm	S.P.
2 Feet	Std.	8"	120	0.05"	95	0.03"	70	0.02"
2 Feet	Tall	10"	150	0.08"	120	0.05"	90	0.03"
3 Feet	Std.	8"	185	0.10"	145	0.06"	110	0.04"
3 Feet	Tall	10"	230	0.15"	185	0.10"	140	0.06"
4 Feet	Std.	8"	250	0.16"	200	0.10"	150	0.06"
4 Feet	Tall	10"	310	0.24"	250	0.16"	185	0.09"
5 Feet	Std.	8"	315	0.23"	250	0.15***	190	0.08"
5 Feet	Tall	12"	480	0.54"	385	0.35***	290	0.20"
6 Feet	Std.	8"	380	0.32"	305	0.21***	230	0.12"
6 Feet	Tall	12"	580	0.75"	465	0.48***	350	0.27"
8 Feet	Std.	8"	510	0.18"	410	0.12**†	310	0.07"
8 Feet	Tall	12"	775	0.42"	620	0.27**†	465	0.15"

** Static pressure when one center exhaust opening is used.

† Static pressure when two outer exhaust openings are used. Requires "T" Connector 3981600, not included. Contact Labconco.

†† Contact Labconco for more information.



*U.S. Patent No. 6,461,233



Ordering Information & Dimensional Data

Protector® XVS™ Ventilation Stations

Protector® XVS™ Ventilation Stations

Nominal Width	Catalog Number	Overall Height (E) in./cm	Overall Depth (H) in./cm	(A) in./cm	(B) in./cm	(C) in./cm	(D) in./cm	(F) in./cm	(G) in./cm	(I) in./cm	(J) in./cm	(K) in./cm	Ship. Wt. lbs./kg
2 Feet	4862010	22.8/57.9	29.0/73.7	24.0/61.0	12.0/30.5	21.6/54.9	28.6/72.6	22.3/56.6	19.0/48.3	23.4/59.4	8.0/20.3	—	105/48
2 Feet	4862030	32.0/81.3	29.0/73.7	24.0/61.0	12.0/30.5	21.6/54.9	37.8/96.0	31.5/80.0	27.7/70.4	23.4/59.4	10.0/25.4	—	135/61
3 Feet	4863010	22.8/57.9	29.0/73.7	36.0/91.4	18.0/45.7	33.6/85.3	28.6/72.6	22.3/56.6	19.0/48.3	23.4/59.4	8.0/20.3	—	135/61
3 Feet	4863030	32.0/81.3	29.0/73.7	36.0/91.4	18.0/45.7	33.6/85.3	37.8/96.0	31.5/80.0	27.7/70.4	23.4/59.4	10.0/25.4	—	160/73
4 Feet	4864010	22.8/57.9	29.0/73.7	48.0/121.9	24.0/61.0	45.6/115.8	28.6/72.6	22.3/56.6	19.0/48.3	23.4/59.4	8.0/20.3	—	160/73
4 Feet	4864030	32.0/81.3	29.0/73.7	48.0/121.9	24.0/61.0	45.6/115.8	37.8/96.0	31.5/80.0	27.7/70.4	23.4/59.4	10.0/25.4	—	185/84
5 Feet	4865010	22.8/57.9	29.0/73.7	60.0/152.4	30.0/76.2	57.6/146.3	28.6/72.6	22.3/56.6	19.0/48.3	23.4/59.4	8.0/20.3	10.0/25.4	290/132
5 Feet	4865030	32.0/81.3	29.0/73.7	60.0/152.4	30.0/76.2	57.6/146.3	37.8/96.0	31.5/80.0	27.7/70.4	23.4/59.4	12.0/30.5	10.0/25.4	340/154
5 Feet*	4865060	32.0/81.3	35.5/90.2	60.0/152.4	30.0/76.2	57.6/146.3	37.8/96.0	31.5/80.0	27.7/70.4	30.0/76.2	12.0/30.5	10.0/25.4	380/172
6 Feet	4866010	22.8/57.9	29.0/73.7	72.0/182.9	36.0/91.4	69.6/176.8	28.6/72.6	22.3/56.6	19.0/48.3	23.4/59.4	8.0/20.3	10.0/25.4	340/154
6 Feet	4866030	32.0/81.3	29.0/73.7	72.0/182.9	36.0/91.4	69.6/176.8	37.8/96.0	31.5/80.0	27.7/70.4	23.4/59.4	12.0/30.5	10.0/25.4	395/179
6 Feet*	4866060	32.0/81.3	35.5/90.2	72.0/182.9	36.0/91.4	69.6/176.8	37.8/96.0	31.5/80.0	27.7/70.4	30.0/76.2	12.0/30.5	10.0/25.4	440/220
8 Feet	4868010	22.8/57.9	29.0/73.7	96.0/243.8	48.0/121.9	93.6/237.7	28.6/72.6	22.3/56.6	19.0/48.3	23.4/59.4	8.0/20.3	24.0/61.0	455/206
8 Feet	4868030	32.0/81.3	29.0/73.7	96.0/243.8	48.0/121.9	93.6/237.7	37.8/96.0	31.5/80.0	27.7/70.4	23.4/59.4	12.0/30.5	24.0/61.0	520/236
8 Feet*	4868060	32.0/81.3	35.5/90.2	96.0/243.8	48.0/121.9	93.6/237.7	37.8/96.0	31.5/80.0	27.7/70.4	30.0/76.2	12.0/30.5	24.0/61.0	580/263

*Includes waste chute

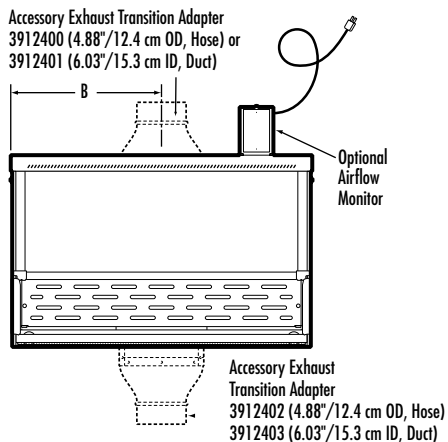

FRONT
(2', 3', 4' MODELS)

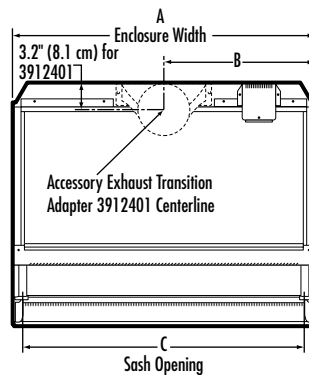

TOP
(2', 3', 4' MODELS)

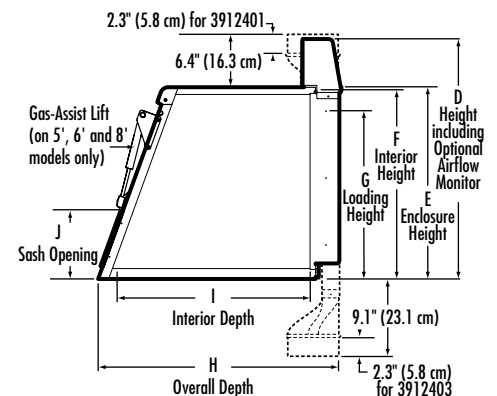

SIDE (ALL MODELS)

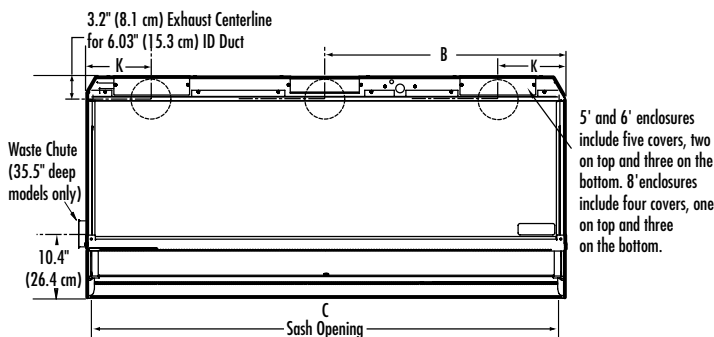

TOP
(5', 6', 8' MODELS)

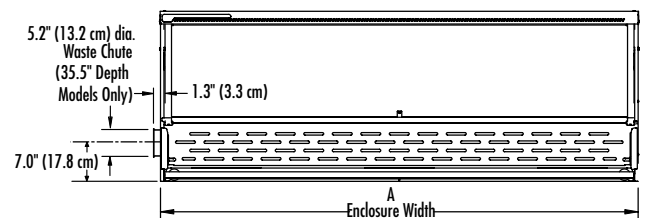

FRONT
(5', 6', 8' MODELS)

Contact Labconco at 800-821-5525 or 816-333-8811 or visit www.labconco.com for detailed AutoCAD drawings.



Protector® Demonstration Hoods



Protector Demonstration Hood System 3945001.

Protector Demonstration Hoods are low profile, light-duty fume hoods designed to provide 360° of close observation of procedures during educational demonstrations.

All models feature:

- Deep 23" interior that easily accommodates a variety of apparatus.
- Patented* Clean-Sweep™ air foil that allows air to sweep the work surface for maximum containment. Airflow openings pull inflow air from under the air foil so that clean air continually flows through the air foil creating a constant barrier of protection from contaminants.
- Upper containment sash foil that bleeds air into the enclosure to direct concentrations of contaminants away from the operator's breathing zone.
- Upper dilution air supply that introduces room air at the top of the sash to dilute concentrations in the upper chamber and bathes the back of the sash with clean air.
- Clear rear baffle that directs air streams to the back of the interior for removal through the exhaust connection. The baffle may be pivoted downward for cleaning.
- Side-entry air foils that allow air to sweep across the interior glass surfaces to enhance containment.
- Sturdy glacier white and gray powder-coated aluminum frame.

- Tempered safety glass front sash, sides, rear baffle and top that offer excellent 360° visibility, ambient light and protection. Glass provides better fire, scratch and corrosion resistance than acrylic.
- 8" high sash opening that limits exhaust demand, conserves costly tempered room air and requires a smaller remote blower than most fume hoods. Tall models, 32.0" high, have a 10" high sash opening.
- Ergonomic angled sash allows a closer view, reduces glare and provides a more comfortable operating position than vertical sashes. Models, 22.8" high, have a 20° angle; models, 32.0" high, have a 14° angle. The hinged sash pivots upward and locks to a loading height of 19.0" or 27.7" depending on the model.
- Lower exhaust tissue screen.
- Two utility ports with iris openings that allow passage of tubing, electrical cords and interface cables from inside to back exterior for connection to services.
- Flexible exhaust options. 2" x 10" rectangular exhaust collars on the top and bottom allow the Protector Demonstration Hood to be connected to ductwork for exhausting to the outside or to a FilterMate Portable Exhauster for filtered removal of fumes and/or particulates. Using the bottom exhaust collar keeps ductwork hidden, maximizing room visibility.

All models conform to the following regulations and standards:

- SEFA 1-2010
- Modified ASHRAE 110-1995
- ANSI Z9.5-2011
- UL 61010-1 (115 volt models)
- CAN/CSA C22.2 No. 61010.1 (115 volt models)
- CE Conformity Marking (230 volt models)
- SEFA 8-2010, Cabinet Surface Finish Tests

System Models 3945000, 3945001, 3945020 & 3545021 also include:

- Cart of glacier white powder-coated tubular steel with black 1" thick solid epoxy dished work surface, handle bar, bottom shelf and 4" diameter toe-locking casters.
- FilterMate Portable Exhauster designed for use with two Carbon Filters or one Carbon Filter and one HEPA Filter (Filters are not included. See page 22 for ordering information.) Includes 8 feet of 5" ID flexible gray polypropylene hose, two clamps, a 4.9" OD Lower Transition Adapter for connection to the bottom of the Protector Demonstration Hood, and an IEC 3-wire electrical cord with plug.

Models 3944300 & 3944301 require:

- **Connection to a remote blower, house exhaust or FilterMate Portable Exhauster.** See pages 20-21 for FilterMate. See pages 26-27 and back cover for Remote Blowers and ductwork.
- **Work surface and supporting base.** See page 25 for Cart. See page 25 for work surface.

Accessories include (see pages 25-27 and back cover):

- **Fluorescent Task Lights.**
- **Exhaust Transition Adapters.**
- **Exhaust Dampers.**
- **Guardian Airflow Monitors.**
- **Cart.**
- **Remote Blowers.**

Contact Labconco at **800-821-5525** or **816-333-8811** for blower sizing assistance and ordering information on accessories not included in this brochure.

Nominal Width	Overall Height	Sash Opening Height	Total Exhaust CFM and Static Pressure					
			100 fpm	S.P.	80 fpm	S.P.	60 fpm	S.P.
3 Feet	22.8"	8"	185	0.10"	145	0.06"	110	0.04"
3 Feet	32.0"	10"	230**	0.15"	185	0.10"	140	0.06"

■ Exclusive Feature * U.S. Patent No. 6,461,233

** FilterMate Portable Exhauster with two filters provides up to 220 CFM and with single filter provides up to 270 CFM.



Ordering Information & Dimensional Data

Protector® Demonstration Hoods

Nominal Width	Catalog Number	Electrical Requirements	Enclosure Height	Shipping Weight lbs./kg
Protector Demonstration Hoods				
3 Feet	3944300	not applicable	22.8"	75/34
3 Feet	3944301	not applicable	32.0"	85/39
Protector Demonstration Hood Systems —include Cart with Work Surface, Lower Transition Adapter and FilterMate Portable Exhauster for use with two Carbon Filters or one Carbon Filter and one HEPA Filter in any combination.*				
3 Feet	3945000	115 volts, 60 Hz, 10 amps	22.8"	125/57
3 Feet	3945001	115 volts, 60 Hz, 10 amps	32.0"	135/61
3 Feet	3945020**	230 volts, 50/60 Hz, 5 amps	22.8"	125/57
3 Feet	3945021**	230 volts, 50/60 Hz, 5 amps	32.0"	135/61

* Filters are required but not included. See page 22 for ordering information.

** International electrical configuration

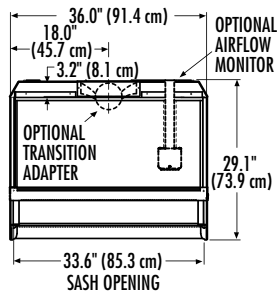

TOP
(3944300 & 3944301)

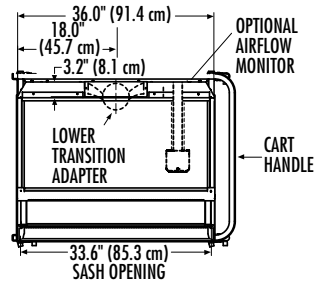

TOP
(3945000, 3945001,
3945020 & 3945021)

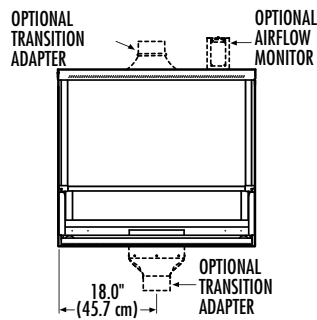

FRONT
(3944300 & 3944301)

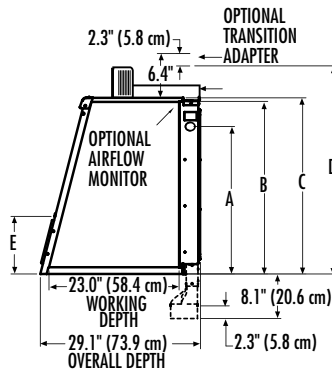

SIDE
(3944300 & 3944301)

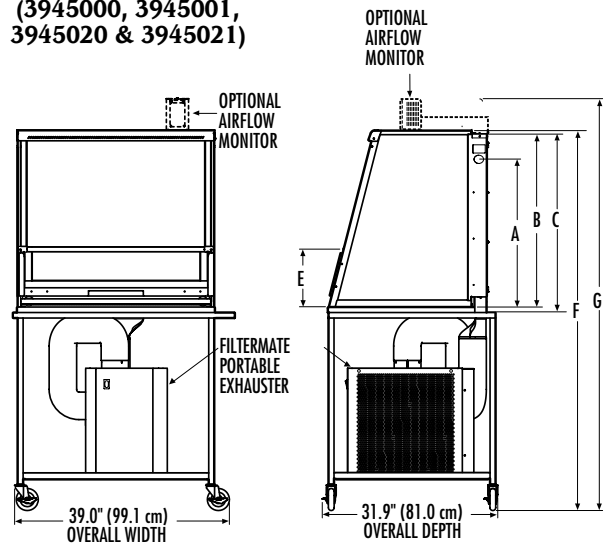

FRONT
(3945000, 3945001,
3945020 & 3945021)

SIDE
(3945000, 3945001,
3945020 & 3945021)

	A	B	C	D	E	F	G
3944300, 3945000 & 3945020	19.0" (48.3 cm) loading height	22.3" (56.4 cm) interior height	22.8" (57.9 cm) enclosure height	28.6" (72.6 cm) height w/ monitor	8.0" (20.3 cm) sash opening	58.8" (149.4 cm) height w/cart	64.6" (164.1 cm) height w/cart & monitor
3944301, 3945001 & 3945021	27.7" (70.4 cm) loading height	31.5" (80.0 cm) interior height	32.0" (81.3 cm) enclosure height	37.9" (96.3 cm) height w/ monitor	10.0" (25.4 cm) sash opening	68.0" (172.7 cm) height w/cart	73.9" (187.7 cm) height w/cart & monitor



FilterMate™ Portable Exhausters



FilterMate Portable Exhauster 3970000. Includes HEPA filter.



FilterMate Portable Exhauster 3970001. **Requires carbon filter (not included).**



FilterMate Portable Exhauster 3970002. Includes HEPA filter and thimble connection. **Requires ducting to outside.**



FilterMate Portable Exhauster 3970003. Includes HEPA filter. **Requires carbon filter (not included).**

An accessory for the Protector XVS Ventilation Station, Protector Demonstration Hood, Protector Work Station and XPert® Balance Enclosure, the FilterMate uses a HEPA filter, carbon filter or a combination of both filters to remove hazardous powders, particulates or vapors from the exhaust air stream and return filtered air to the environment.

All models feature:

- Compact, corrosion-resistant housing of glacier white and light gray powder-coated steel with rubber feet.
- Variable-speed, non-sparking motorized impeller.
- Quiet operation. Oversized HEPA filter, efficient impeller and perforated exhaust cover work together to provide lower system exhaust velocity and noise pressure levels.

Exhaust CFM	Noise Pressure dB(A)
100	45-47
150	51-54
200	56-61
250	63-65

- Inherently safe design. A negative pressure plenum surrounds the positive pressure impeller so that if a leak occurs, the unfiltered air is captured and refiltered.
- Sized for Protector Demonstration Hoods, Protector XVS Ventilation Stations, Protector Work Stations and XPert Balance Enclosures. Capable of efficiently filtering up to 250 CFM for HEPA or carbon filtration; up to 200 CFM for combination HEPA/carbon filtration (60-100 fpm depending on enclosure model).
- Front-mounted rocker switch to control power to the blower.
- Rear-mounted, auxiliary electrical outlet that may be connected to an airflow monitor or other user-supplied accessories.
- Only one FilterMate is required for all 2', 3' and 4' wide enclosures. Multiple FilterMates may be used for 5', 6' and 8' wide enclosures.

Exclusive Feature

- Included: 8 feet of 5" ID flexible gray polypropylene hose, two clamps and a 4.9" OD Upper Transition Adapter for connection to the top of the Protector XVS Ventilation Station or Protector Demonstration Hood. Models 3970004 and 3970024 include a 4.9" OD Lower Transition Adapter instead of the Upper Transition Adapter.
- 6.5' IEC three-wire electrical cord with plug (115 volt models).
- 9' IEC three-wire electrical cord. **An electrical plug is required (230 volt models).**

All models conform to the following regulations and standards:

- UL 61010-1
- CAN/CSA C22.2 No. 61010.1
- CE Conformity Marking (230 volt models)

Models 3970000, 3970020, 3970002, 3970022, 3970003 and 3970023 feature:

- HEPA filter, 99.99% efficient on particulates 0.3 micron in size.
- True bag-in/bag-out filter disposal system for safely removing and replacing the filter without detaching the hose. The HEPA filter may be easily accessed by removing the exhaust cover for field leak testing by a certified technician.

Models 3970002 and 3970022 feature:

- 6.1" ID thimble connection from the FilterMate to an existing house exhaust system for added safety.

Models 3970001, 3970021, 3970003 and 3970023 require one each and Models 3970004 and 3970024 require two each (not included):

- Carbon Filter. Organic Vapor, Formaldehyde or Ammonia Filters are offered. See page 22.

Optional Accessories:

- Replacement HEPA Filter. See page 22.
- Replacement Bag-In/Bag-Out Bag. See page 22.
- Flexible Hose. See page 26.
- Thimble Connection. See page 26.





Ordering Information & Dimensional Data

FilterMate™ Portable Exhausters

FilterMate™ Portable Exhausters

Catalog Number	Filter Usage	Overall Dimensions	Electrical Requirements	Airflow Potential	Exhaust Connection	Shipping Weight lbs./kg
3970000	HEPA included	14.0" w x 23.0" d x 22.7" h	115 volts, 60 Hz	250 CFM (60-100 fpm)	None. Room exhaust.	50/23
3970020*	HEPA included	14.0" w x 23.0" d x 22.7" h	230 volts, 50 Hz	250 CFM (60-100 fpm)	None. Room exhaust.	50/23
3970001	Carbon required [†]	14.0" w x 23.0" d x 22.7" h	115 volts, 60 Hz	250 CFM (60-100 fpm)	None. Room exhaust.	48/22
3970021*	Carbon required [†]	14.0" w x 23.0" d x 22.7" h	230 volts, 50 Hz	250 CFM (60-100 fpm)	None. Room exhaust.	48/22
3970002	HEPA included	18.6" w x 23.0" d x 24.7" h	115 volts, 60 Hz	250 CFM (60-100 fpm)	6.06" ID Thimble to outside	54/25
3970022*	HEPA included	18.6" w x 23.0" d x 24.7" h	230 volts, 50 Hz	250 CFM (60-100 fpm)	6.06" ID Thimble to outside	54/25
3970003	HEPA included ^{††} Carbon required [†]	14.9" w x 23.0" d x 22.7" h	115 volts, 60 Hz	200 CFM (60-100 fpm)**	None. Room Exhaust.	52/24
3970023*	HEPA included ^{††} Carbon required [†]	14.9" w x 23.0" d x 22.7" h	230 volts, 50 Hz	200 CFM (60-100 fpm)**	None. Room Exhaust.	52/24
3970004	Two Carbon required [†]	14.9" w x 23.0" d x 22.7" h	115 volts, 60 Hz	200 CFM (60-100 fpm)**	None. Room Exhaust.	52/24
3970024	Two Carbon required [†]	14.9" w x 23.0" d x 22.7" h	230 volts, 50 Hz	200 CFM (60-100 fpm)**	None. Room Exhaust.	52/24

* International electrical configuration

[†] Carbon Filter is not included.

^{††} HEPA filter may be removed and substituted with a second carbon filter.

** 60-80 fpm on 4' enclosure.

Models 3970000, 3970001, 3970020 & 3970021

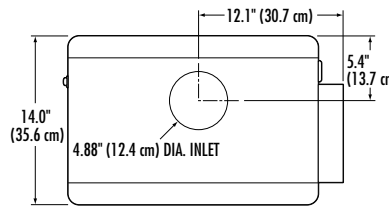

TOP

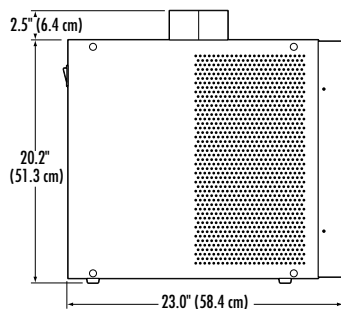

SIDE

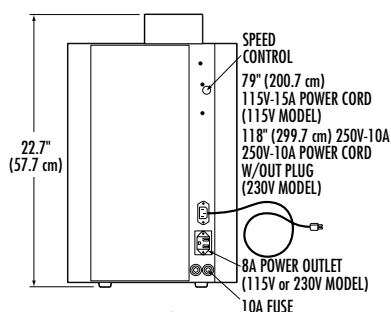

REAR

Models 3970002 & 3970021

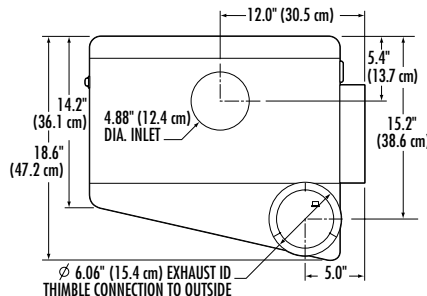

TOP

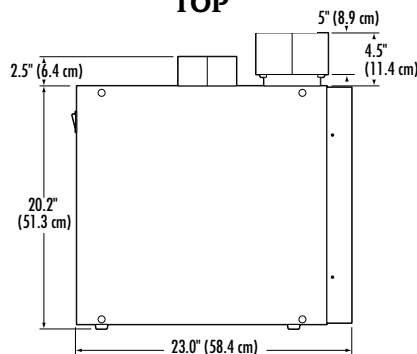

SIDE

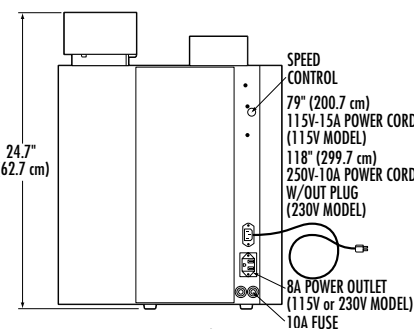

REAR

Models 3970003 & 3970023

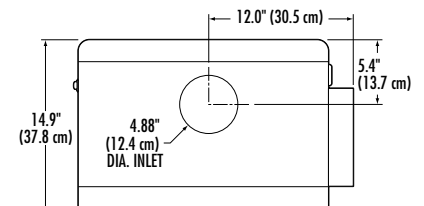

TOP

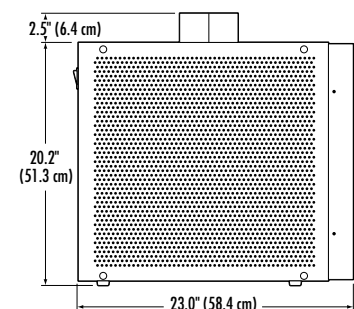

SIDE

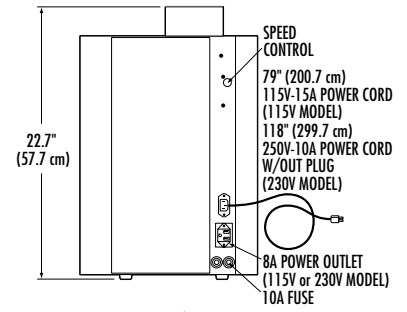

REAR



Carbon and HEPA Filters

FilterMate™ Portable Exhausters

Below is an Application Matrix that provides examples of appropriate uses for carbon and/or HEPA filters expended in the FilterMate Portable Exhauster. Whether or not any ductless enclosure is appropriate for your application requires consideration of factors such as the time-weighted exposure limits of your materials. Using Labconco's exclusive chemical assessment program, our technical specialists can help you determine if a Labconco ductless enclosure is the right ventilation product for your application

and, if so, estimate filter life. To begin the process, please complete the **Chemical Usage Assessment Form** available on our website at www.labconco.com or call us at **800-821-5525** or **816-333-8811**.

Carbon and HEPA Filters are available in a variety of types and, in some cases, may be used in carbon/HEPA filter combination. An online **Chemical Guide**, available at www.labconco.com, allows you to search individual chemicals to determine their suitability for use with a carbon-filtered enclosure.

- **Organic Filters** are suitable for vapors from solvents including acetone, ethyl acetate, toluene and xylene.
- **Formaldehyde Filters** are suitable for vapors from formaldehyde, formalin and glutaraldehyde.
- **Ammonia Filters** are suitable for ammonia and low molecular weight amines.
- **HEPA Filters**, 99.99% efficient, are suitable for removing particulates such as powders and pollen. **They should not be used to capture biohazardous materials or volatile organic material.**

Application Matrix

Filter Type Configuration	FilterMate & Protector Work Station			FilterMate	
	Organic	Ammonia	Formaldehyde	Carbon & HEPA*	HEPA
Asbestos handling					•
Clean room/critical environment				•	
Combination dry and liquid chemicals				•	
Drug compounding/research				•	•
Endoscopy instrument cleaning			•		
Histology/cytology tissue staining, coverslipping	•				
Histology/pathology	•			•	
Hormone research				•	•
Non-biohazardous microbiological samples with trace chemicals**				•	
Particulates in conjunction with chemical agents				•	
Pathology/tissue grossing			•	•	
Photo-engraving		•			
Plastics production		•			
Pollen handling				•	•
Soldering				•	•
Solvent cleaning	•				
Solvent welding/gluing	•				
Weighing chemical powders				•	•

*Carbon filter type varies based on application

**The FilterMate Portable Exhauster is not designed to accommodate changing and disposing of biohazardous filters and materials and, therefore, should not be used as part of a biosafety enclosure.



Carbon and HEPA Filters and Accessories for use with FilterMate Portable Exhausters

A HEPA Filter and Bag-In/Bag-Out Bag are included with FilterMate Portable Exhausters designed for use with HEPA filters. One or two Carbon Filters are required for operation with FilterMate Portable Exhausters designed for use with carbon filters.

Catalog #	Description	Shipping Wt. lbs./kg
3923400	Organic Carbon Filter, Type AC. Contains 12 pounds of granular activated carbon media.	14/6
3923401	Formaldehyde Carbon Filter, Type ST-1. Contains a minimum of 14 pounds of impregnated carbon media.	17/8
3923402	Ammonia Carbon Filter, Type AC. Contains a minimum of 16 pounds of impregnated carbon media.	21/10
3707900	Replacement HEPA Filter, 99.99% efficient on particles 0.3 micron in size.	10/5
3776002	Replacement Bag-In/Bag-Out Bag to ensure containment of particulate matter during HEPA filter changing.	1/0.5
1968800	Orange Cinching Strap for Bag-In/Bag-out Bag.	1/0.5

*Labconco strongly recommends ordering and keeping an extra set of filters to have readily available when filters become saturated and require replacement. Sign up for the **Filter Reminder Email Service** at www.labconco.com.



Canopy Hoods



Canopy Hood 4799000. Blower and ductwork must be ordered separately.

The Canopy Hood is specifically **designed to vent non-toxic materials such as heat, steam and odors** from large or bulky apparatus such as ovens, steam baths and autoclaves. The hood may be installed on a wall or suspended from the ceiling for peninsular and corner locations. **For most efficient performance, the hood should be installed no more than 12" above the equipment to be ventilated.** Coupled with a blower and ductwork, the Canopy Hood can operate at a wide range of exhaust rates.

Features:

- Glacier white powder-coated steel construction.
- Integral baffle.
- Fully assembled.
- Include mounting hardware for installation on wall or suspended from ceiling. **Threaded rod is required for suspension from ceiling.**

Required accessories not included:

- **Remote Blower.**
- **Ductwork.**

Nominal Width	Catalog Number	Shipping Weight lbs./kg
4 Feet	4799000	140/64
6 Feet	7099000	205/93

4' Canopy Hood 4799000

CFM at Static Pressure – Inches H₂O

0.12"	0.19"	0.22"	0.36"	0.39"	0.73"	2.45"
325	450	488	650	675	975	1950

6' Canopy Hood 7099000

CFM at Static Pressure – Inches H₂O

0.17"	0.24"	0.31"	0.45"	0.49"	0.89"	2.50"
425	550	638	825	850	1275	2550

Dimensional Data

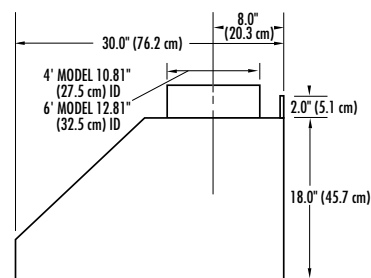

SIDE

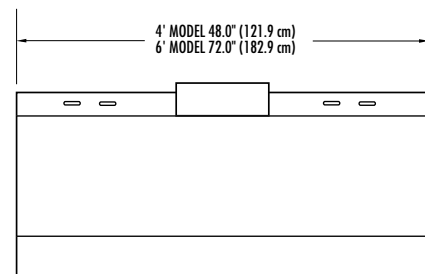

FRONT

Contact Labconco at **800-821-5525** or **816-333-8811** for blower sizing assistance and ordering information on accessories not included in this brochure.



Flat Work Surfaces & Accessories

Flat Solid Epoxy Work Surfaces

For Use with Labconco
Enclosures including
Fiberglass 30 and
Basic Laboratory Hoods*

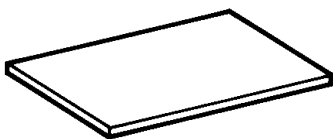

Catalog #	Description	Shipping Wt. lbs./kg
4882806	30" w x 30" d x 1.25" thick, no cutouts	86/39
4882805	36" w x 30" d x 1.25" thick, no cutouts	90/41
4882803	48" w x 30" d x 1.25" thick, no cutouts	110/50
4882804	72" w x 30" d x 1.25" thick, no cutouts	205/93

Spillstopper™ & Flat Work Surface Accessories

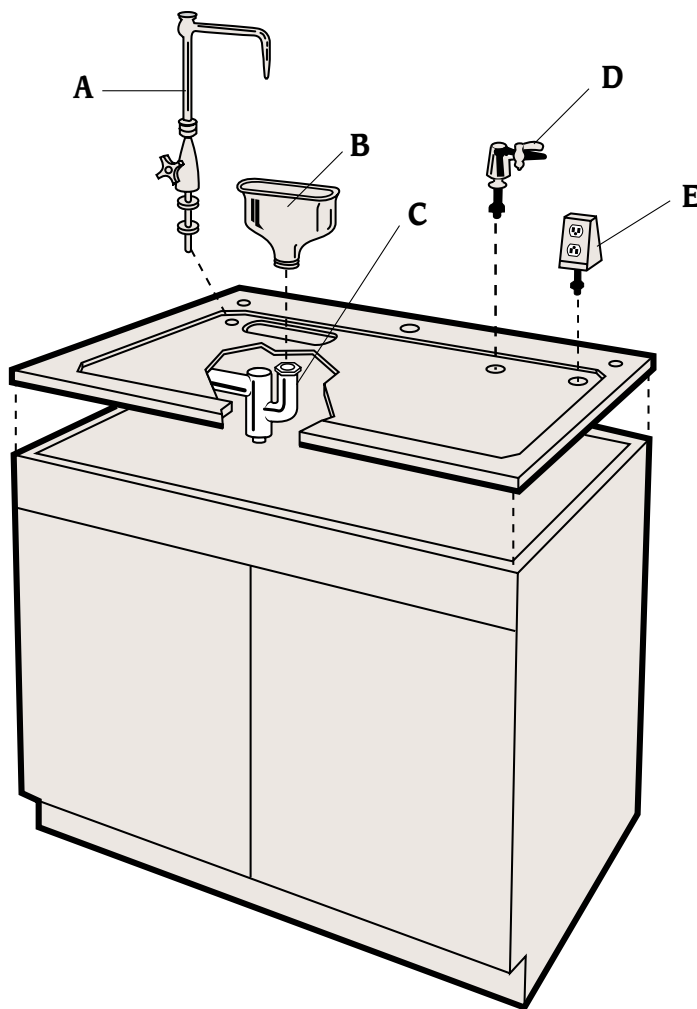

- (A) **4005100 Cold Water Faucet with Rigid Gooseneck** Factory-drilled mounting hole in work surface is required. Shipping weight 4 lbs. (1.8 kg)
- (A) **4005900 Cold Water Faucet with Rigid Gooseneck and Vacuum Breaker** Factory-drilled mounting hole in work surface is required. Shipping weight 4 lbs. (1.8 kg)
- (B) **4005200 Oval Polypropylene Cupsink** Mounts in work surface with cupsink cutout. 3" x 6". 1.5" NPSM** thread. Shipping weight 4 lbs. (1.8 kg)
- 4005201 Cupsink Cover** Black solid epoxy resin cover for oval cupsink cutout. Provides a continuous work surface when a cupsink is not in use. 7.4" wide x 4.4" deep x 0.3" thick (19 x 12 x 0.8 cm). Shipping weight 2 lbs. (0.9 kg)
- (C) **4005400 Trap, Lead** 1.5" diameter drum with coupling nut. For use with cupsink. Shipping weight 10 lbs. (4.5 kg)

- (C) **1432600 Trap, PVC** 1.5" diameter drum with coupling nut. For use with cupsink. Shipping weight 10 lbs. (4.5 kg)
- 1361100 Sepia Bronze-Coated Cold and Hot Water Mixing Faucet with Swivel Gooseneck** Not shown. Factory-drilled mounting hole in work surface is required. Shipping weight 4 lbs. (1.8 kg)
- 1361200 Chrome-Plated Cold and Hot Water Mixing Faucet with Swivel Gooseneck** Not shown. Factory-drilled mounting hole in work surface is required. Shipping weight 4 lbs. (1.8 kg)
- (D) **4005000 Service Fixture** Specify air, gas or vacuum. Factory-drilled mounting hole in work surface is required. Shipping weight 4 lbs. (1.8 kg)
- (E) **4005800 Electrical Receptacle** Pedestal-type, 115 volt, 15 amp duplex. Factory-drilled mounting hole in work surface is required. Shipping weight 4 lbs. (1.8 kg)

* Basic Hoods are not as wide or as deep as the work surfaces that support them.

** National Pipe Straight Mechanical



Accessories

Protector® XVS Ventilation Stations & Protector® Demonstration Hoods



Solid Epoxy Work Surfaces

Black work surfaces are contoured to fit the dimensions of Protector XVS Ventilation Stations and Protector Demonstration Hoods and dished to contain spills. One inch thick molded solid epoxy is chemical resistant and fire proof.

Catalog #	Dimensions	For use with:	Shipping Wt. lbs./kg
3908400	24.0" w x 26.7" d	2' Protector XVS	48/22
3908401	36.0" w x 26.7" d	3' Protector XVS, Protector Demonstration Hoods	72/33
3908402	48.0" w x 26.7" d	4' Protector XVS	96/44
3908406	60.0" w x 26.7" d	5' Protector XVS - 29.0" deep models	120/54
3908407	72.0" w x 26.7" d	6' Protector XVS - 29.0" deep models	144/65
3908408	96.0" w x 26.7" d	8' Protector XVS - 29.0" deep models	192/88
3908409	60.0" w x 35.5" d	5' Protector XVS - 35.5" deep models	160/72
3908410	72.0" w x 35.5" d	6' Protector XVS - 35.5" deep models	192/88
3908411	96.0" w x 35.5" d	8' Protector XVS - 35.5" deep models	255/115



Stainless Steel Work Surfaces

Type 304 stainless steel work surfaces are 0.8" thick, have a one inch deep front spill trough and fit dimensions of the Protector XVS Ventilation Stations. Available in 5', 6' and 8' widths.

Catalog #	Dimensions	For use with:	Shipping Wt. lbs./kg
3975500	60.0" w x 26.7" d	5' Protector XVS - 29.0" deep models	140/64
3975501	60.0" w x 35.5" d	5' Protector XVS - 35.5" deep models	180/82
3975600	72.0" w x 26.7" d	6' Protector XVS - 29.0" deep models	170/77
3975601	72.0" w x 35.5" d	6' Protector XVS - 35.5" deep models	220/100
3975800	96.0" w x 26.7" d	8' Protector XVS - 29.0" deep models	240/109
3975801	96.0" w x 35.5" d	8' Protector XVS - 35.5" deep models	290/132



8026000 Cart for Protector Demonstration Hoods

Provides mobile support for Protector Demonstration Hoods and 3' Protector XVS Ventilation Stations. Glacier white powder-coated tubular steel with black 1" thick solid epoxy dished work surface, handle bar, bottom shelf and 4" diameter toe-locking casters. Supports loads up to 400 pounds. Cart is included with Protector Demonstration Hood Systems 3945000, 3945001, 3945020 and 3945021. Dimensions: 39.0" w x 31.9" d x 36.0" h. Shipping weight 50 lbs. (23 kg)



Fluorescent Task Lights

For use with Protector XVS Ventilations Stations and Protector Demonstration Hoods. May be placed atop the enclosure to enhance illumination of the interior. Include auxiliary electrical receptacle with switch for connection of accessories such as a printer or airflow monitor.

Catalog #	Description	Shipping Wt. lbs./kg
3909200	115 volts, 60 Hz, 10 amps. Includes IEC, three-wire cord with plug.	15/7
3909201*	230 volts, 50 Hz, 10 amps. Includes IEC, three-wire cord. Plug is required (not included).	15/7



5248300 Waste Chute Stopper

For use with 5', 6' and 8' Protector XVS Ventilation Stations, 35.5" deep, with waste chute. When waste chute is not in use, the stopper helps prevents contaminants from escaping from the enclosure through the side wall. Solid rubber. 5" diameter. Shipping weight 1 lb. (0.5 kg)



Accessories

Protector® XVS Ventilation Stations & Protector® Demonstration Hoods



3925000 Utility Shelves

For use with Protector XVS Ventilation Stations. Three shelves attach to the rear baffle perforations to hold items such as a balance printer, utensils and other miscellaneous supplies. The utensil shelf has a scalloped front edge to support scalpels, forceps and other items. Powder-coated steel. Shipping weight 5 lbs. (2 kg)



3927700 Bottle Holder

For use with Protector XVS Ventilation Stations. Attaches to the rear baffle perforations to hold a squirt bottle or other round container. Powder-coated steel. 3" diameter opening. Shipping weight 1 lb. (0.5 kg)



3927800 Tissue Holder

For use with Protector XVS Ventilation Stations. Attaches to the rear baffle perforations to hold tissue wipers in the upside down position. An opening in the bottom of the holder permits wipers to be dispensed from the bottom. Powder-coated steel. Shipping weight 1 lb. (0.5 kg)



3912400



3912401



3912402



3912403

Exhaust Transition Adapters

For use with Protector XVS Ventilation Stations and Protector Demonstration Hoods designed for outside ducting or connected to the FilterMate Portable Exhauster. Powder-coated steel.

Catalog #	Description	Shipping Wt. lbs./kg
3912400	Upper Exhaust Transition Adapter, 2.0" x 10.0" rectangular to 5.0" diameter round for connection to 5" ID hose. Included with FilterMate Portable Exhauster.	5/2
3912401	Upper Exhaust Transition Adapter, 2.0" x 10.0" rectangular to 6.0" diameter round for connection to 6" OD duct.	5/2
3912402	Lower Exhaust Transition Adapter, 2.0" x 10.0" rectangular to 5.0" diameter round for connection to 5" ID hose. Included with Protector Demonstration Hood System.	5/2
3912403	Lower Exhaust Transition Adapter, 2.0" x 10.0" rectangular to 6.0" diameter round for connection to 6" OD duct.	5/2

Flexible Hose for FilterMate Portable Exhauster

For use with the FilterMate Portable Exhauster instead of the flexible polypropylene hose included. 8' length. Include two clamps.

Catalog #	Description	Shipping Wt. lbs./kg
3927500	5" ID, clear urethane, smooth bore with white helix, static dissipative, suitable for pharmaceutical and clean room applications.	3/1
3927600	6" ID, black thermoplastic rubber hose with 6.09" ID cuffs, suitable for pharmaceutical and clean room applications. May be used to duct to the outside. Requires 3927400 Adapter, sold separately. See page 27.	3/1

3913600 Thimble Connection Kit

For retrofitting FilterMate Portable Exhausters 3970000, 3970020, 3970001, 3970004 and 3970024. Included with FilterMate Portable Exhausters 3970002 and 3970022. Shipping weight 10 lbs. (4 kg)

**International electrical configuration.*



Accessories

Protector® XVS Ventilation Stations & Protector® Demonstration Hoods

Ductwork

Catalog #	Description	Equivalent Resistance [†]	Shipping Wt. lbs./kg
4708600	Thermoplastic Duct, 6.625" OD, 6.25" ID, 10' length	10'	25/11
4708900	Female PVC Duct Coupling, 6" nominal diameter, connects two sections of Thermoplastic Duct	0'	4/2
4708700	90° PVC Elbow, 6" nominal diameter, has belled end connections to directly receive Thermoplastic Duct or Male Duct Coupling	12'	1/0.5
3924000	Manual Exhaust Damper, powder-coated steel, 6" nominal diameter	1'	1/0.5
4724200	Manual Exhaust Damper, PVC, 6" nominal diameter	1'	1/0.5
4861800	Flexible Duct Connection, 7" nominal diameter, for use with 6" nominal diameter duct	1'	8/4
3927400	Adapter, 5" round to 6" round, for use with 3927600 Hose	1'	1/0.5
4861700	Blower Transition Adapter, 4.25" x 7.75" rectangle to 6" diameter round	1'	3/1
4722200	Zero Pressure Weathercap, 6" nominal diameter, fits atop Thermoplastic Duct	5'	20/9

[†]Equivalent resistance is measured in feet of straight duct.



Remote Blowers

A remote blower is required when ducting the Protector XVS Ventilation Station or Protector Demonstration Hood to the outside. The direct drive blower has a 1/4 hp TEFC-type motor and overcomes external static pressure of 0.5" at 420 CFM. Housing and impeller are corrosion-resistant, phenolic-coated steel. Blower inlet is 5.94" OD and is sized to accept 6" nominal diameter PVC duct. Blower outlet is 4.25" x 7.4" OD. Dimensions: 14.6" w x 13.5" d x 13.25" high.

Catalog #	Electrical Requirements	Shipping Wt. lbs./kg
4863500	115 volts, 60 Hz, 4.4 amps	35/16
4863501*	115/230 volts, 50 Hz, 5.6/2.8 amps	35/16
7053501**	115 volts, 60 Hz 4.4 amps	40/18

CFM @ Static Pressure-Inches of H ₂ O						
S.P.	0.0"	0.125"	0.25"	0.50"	0.75"	0.87"
CFM	595	560	515	420	300	167

See Labconco Blower Booklet for more information.

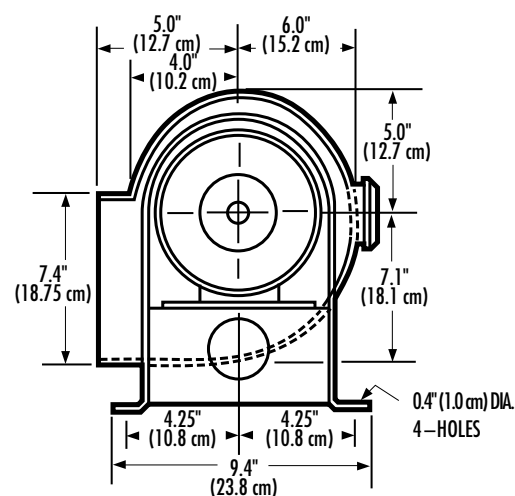
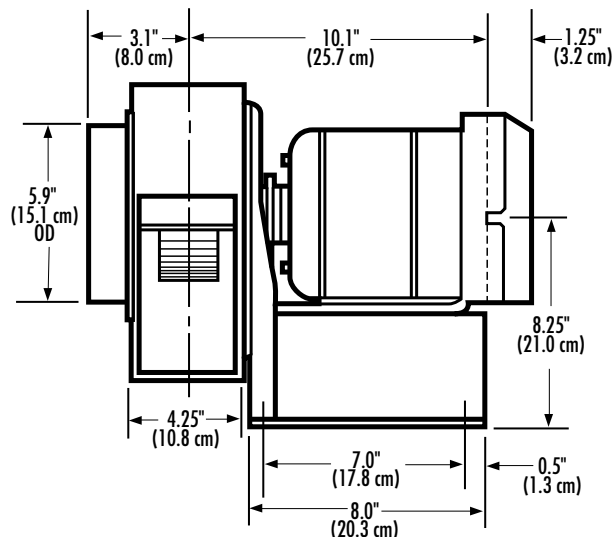

* International electrical configuration. **Explosion-proof



Accessories

Protector® XVS Ventilation Stations & Protector® Demonstration Hoods

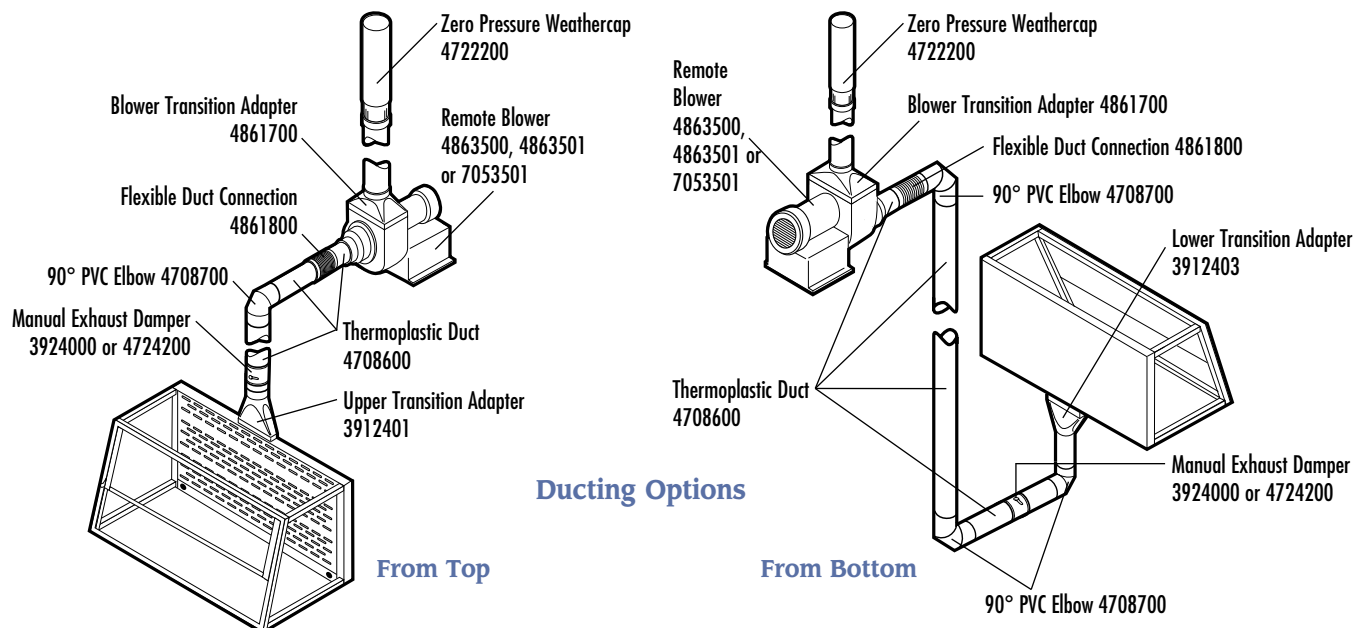

Ducting Options



Guardian™ 1000 Digital Airflow Monitors

Mount atop Protector XVS Ventilation Stations and Protector Demonstration Hoods in factory-prepared location. Monitor and alert the operator to low airflow conditions. Include face plate with circuit board, electrical power pack, airflow hose, flow hose adapter and glacier white powder-coated steel casing. LCD displays actual airflow in fpm or m/sec from 0 to 999 fpm (0 to 5.0 m/s). Audible/visual alarm alerts user to sustained low velocity condition. Calibration instructions displayed on LCD. LED lights display red for alarm, yellow for caution, green for normal. Include temperature-compensated sensor, external alarm, RS-232 port, night setback and alarm mute functions. UL* and CE listed.

Catalog #	Electrical Requirements	Shipping Wt. lbs./kg
3908800	115 volts, 60 Hz	10/5
3908801**	230 volts, 50 Hz	10/5



Guardian™ 500 Airflow Monitors

Mount atop Protector XVS Ventilation Stations and Protector Demonstration Hoods in factory-prepared location. Include face plate with circuit board, electrical power pack, tubing, airflow tube adapter and glacier white epoxy-coated steel casing. From the monitor's face plate, the user can easily select and calibrate a setpoint between 30 and 250 fpm using a velocity meter and a screwdriver. A green LED glows to indicate "safe" when airflow is greater than the low setpoint. A red LED flashes to indicate "low" when airflow is below the low setpoint. An amber LED flashes when the sash is raised above the maximum safe working opening. An audible alarm sounds (and can be muted) when under "low" and "sash high" conditions. Include night setback, external alarm and alarm mute functions.

Catalog #	Electrical Requirements	Shipping Wt. lbs./kg
3944700	115 volts, 60 Hz	10/5
3944701**	230 volts, 50 Hz	10/5

*UL is a registered trademark of UL, LLC. **International electrical configuration



Labconco Corporation • 8811 Prospect Avenue • Kansas City, MO 64132-2696
800-821-5525 or 816-333-8811 • www.labconco.com

