

"Apollo"[®] INTERNATIONAL

SUBMITTAL SHEET

LEAD FREE 94ALF-A Series

Full Port Brass Ball Valve



Job Name:	
Job Location:	
Engineer:	
Contractor:	
Tag:	
PO Number:	
Representative:	
Wholesale Distributor:	



DESCRIPTION

The **Apollo International™** 94ALF-A Lead Free* forged brass ball valves combine reliable operation with maximum economy. Now with multi-agency approvals, the 94ALF-A is ideal for gas, fuels, fire protection and general plumbing and HVAC applications including potable water. Valves are ANSI 3rd party Lead Free* certified.

FEATURES

- Lead Free* materials and certification
- Distinctive white "Lead Free" handle grip and blue "Lead Free" hang tag
- 2-Piece, Full-Port design
- Blow-out Proof Stem
- Adjustable Stem Packing Nut
- Multiple agency approvals

PERFORMANCE RATING

- Valve Design Rating:
600 CWP – 1/4" to 2"
400 CWP – 2-1/2" to 4"
- Temperature Range: -20°F to 366°F

APPROVALS

- MSS SP-110 - Ball Valves...
- NSF/ANSI 61-8, Annex F & G
- NSF/ANSI 372 Lead Free
- IAPMO IGC 157 (cUPC)
- ANSI Z21.15 (1/2 psi) (CSA 9.1) (1/4" – 2")
- ASME B16.44 (5 psi) (CR91-002) (1/4" – 2")
- ASME B16.33 (125 psi) (CGA 3.16) (1/2" – 2")
- **UL:** Guides YQNZ, YRBX, YRPV, YSDT (1/2" - 4") & MHKZ (1/4" - 4" NPT only)
- UL 258 – VQGU Trim & Drain 175# max (1/4" – 2")
- FM 1140 (1/4" - 2" NPT & Solder)

Note: Gas approvals apply to NPT valves only

STANDARD MATERIALS LIST

Part Name	Material
Body	Lead Free Brass (DZR)
Retainer	Lead Free Brass (DZR)
Ball 1/4" - 1"	Lead Free Brass (DZR), Chr. Plated
Ball 1-1/4" - 4"	SS Type 316
Stem	Brass C36000
Seats	PTFE
Stem Packing	PTFE
Gland Nut	Brass, C37700
Seal	PTFE
Handle	Steel, plated (with PVC grip)
Handle Nut	Steel, plated

DIMENSIONS

Part Number	Size (in.)	Dimensions (in.)					Wt. (lbs.)	Options	Options
		A	B	C	D	E		2-1/4" Stem Extension Kit	Replacement Lever Handles
NPT									
94ALF-101-01A	1/4"	0.39	1.76	1.73	3.54	-	0.29	78217101	W234700
94ALF-102-01A	3/8"	0.39	1.76	1.73	3.54	-	0.30	78217201	W234800
94ALF-103-01A	1/2"	0.58	2.05	2.04	3.54	-	0.44	78217301	W234900
94ALF-104-01A	3/4"	0.75	2.36	2.26	3.78	-	0.71	78217401	W235000
94ALF-105-01A	1"	0.95	2.76	2.58	4.53	-	1.10	78217501	W235100
94ALF-106-01A	1-1/4"	1.26	3.31	3.05	4.53	-	1.63	78217501	W235100
94ALF-107-01A	1-1/2"	1.58	3.66	3.37	5.51	-	2.41	78217601	W235200
94ALF-108-01A	2"	1.97	4.18	3.70	6.30	-	3.66	78217601	W283000
94ALF-109-01A	2-1/2"	2.52	5.38	4.65	8.66	-	7.60	78217701	W235300
94ALF-100-01A	3"	2.91	6.04	4.97	8.66	-	9.60	78217701	W235300
94ALF-10A-01A	4"	3.90	7.39	6.13	11.02	-	21.00	78217801	W273800

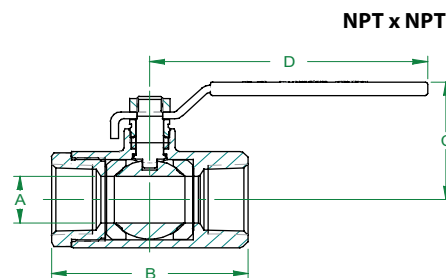

* **LEAD FREE:** The wetted surfaces of this product shall contain no more than 0.25% lead by weighted average. Complies with Federal Public Law 111-380. ANSI 3rd party approved and listed.

Apollo Valves / **Conbraco Industries, Inc.**
701 Matthews Mint-Hill Road, Matthews, NC 28105 USA
www.apollovalves.com | (704) 841-6000

This specification is provided for reference only. Conbraco Industries Inc. reserves the right to change any portion of this specification without notice and without incurring obligation to make such changes to Conbraco products previously or subsequently sold. Please visit our website @ www.apollovalves.com for the most current information.



"Apollo" Valves

SUBMITTAL SHEET

LEAD FREE

94ALF-A Series

Full Port Brass Ball Valve

Solder x Solder

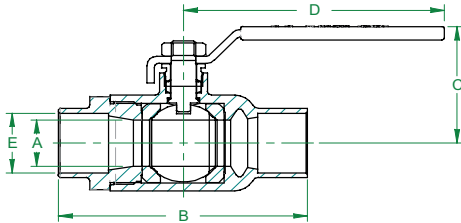

DIMENSIONS

Part Number	Size (in.)	Dimensions (in.)					Wt. (lbs.)	Options	Options
		A	B	C	D	E		2-1/4" Stem Extension Kit	Replacement Lever Handles
SOLDER									
94ALF-203-01A	1/2"	0.58	2.05	1.84	3.54	0.63	0.40	78217201	W234800
94ALF-204-01A	3/4"	0.75	2.75	2.14	3.78	0.88	0.68	78217301	W234900
94ALF-205-01A	1"	0.95	3.31	2.45	4.53	1.13	1.15	78217401	W235000
94ALF-206-01A	1-1/4"	1.26	3.82	3.04	4.53	1.38	1.53	78217501	W235100
94ALF-207-01A	1-1/2"	1.58	4.43	3.17	5.51	1.63	2.31	78217601	W235200
94ALF-208-01A	2"	1.97	5.38	3.49	6.30	2.13	3.77		W283000
94ALF-209-01A	2-1/2"	2.52	6.28	4.66	8.66	2.63	6.79	78217701	W235300
94ALF-200-01A	3"	2.91	7.15	4.87	8.66	3.13	8.67		
94ALF-20A-01A	4"	3.90	9.28	5.87	11.02	4.13	16.67		

Apollo Valves, Manufactured by **Conbraco Industries, Inc.**
 701 Matthews Mint-Hill Road, Matthews, NC 28105 USA
www.apollovalves.com | (704) 841-6000

This specification is provided for reference only. Conbraco Industries Inc. reserves the right to change any portion of this specification without notice and without incurring obligation to make such changes to Conbraco products previously or subsequently sold. Please visit our website @ www.apollovalves.com for the most current information.

